



0 (800) 800 130
(050) 462 0 130
(063) 462 0 130
(067) 462 0 130

130
COM.UA

Internet store of autogoods



km-130

CAR RECEIVERS — Receivers • Media receivers and stations • Native receivers • CD/DVD changers • FM-modulators/USB adapters • Flash memory • Facia plates and adapters • Antennas • Accessories | CAR AUDIO — Car audio speakers • Amplifiers • Subwoofers • Processors • Crossovers • Headphones • Accessories | TRIP COMPUTERS — Universal computers • Model computers • Accessories | GPS NAVIGATORS — Portable GPS • Built-in GPS • GPS modules • GPS trackers • Antennas for GPS navigators • Accessories | VIDEO — DVR • TV sets and monitors • Car TV tuners • Cameras • Videomodels • Transcoders • Car TV antennas • Accessories | SECURITY SYSTEMS — Car alarms • Bike alarms • Mechanical blockers • Immobilizers • Sensors • Accessories | OPTIC AND LIGHT — Xenon • Bixenon • Lamps • LED • Stroboscopes • Optic and Headlights • Washers • Light, rain sensors • Accessories | PARKTRONICS AND MIRRORS — Rear parktronics • Front parktronics • Combined parktronics • Rear-view mirrors • Accessories | HEATING AND COOLING — Seat heaters • Mirrors heaters • Screen-wipers heaters • Engine heaters • Auto-refrigerators • Air conditioning units • Accessories | TUNING — Vibro-isolation • Noise-isolation • Tint films • Accessories | ACCESSORIES — Radar-detectors • Handsfree, Bluetooth • Windowlifters • Compressors • Beeps, loudspeakers • Measuring instruments • Cleaners • Carsits • Miscellaneous | MOUNTING — Installation kits • Upholstery • Grilles • Tubes • Cable and wire • Tools • Miscellaneous | POWER — Batteries • Converters • Start-charging equipment • Capacitors • Accessories | MARINE AUDIO AND ELECTRONICS — Marine receivers • Marine audio speakers • Marine subwoofers • Marine amplifiers • Accessories | CAR CARE PRODUCTS — Additives • Washer fluid • Care accessories • Car polish • Flavors • Adhesives and sealants | LIQUID AND OIL — Motor oil • Transmission oil • Brake fluid • Antifreeze • Technical lubricant



In store "130" you can find and buy almost all necessary goods for your auto in Kyiv and other cities, delivery by ground and postal services. Our experienced consultants will provide you with exhaustive information and help you to chose the very particular thing. We are waiting for you at the address

<https://130.com.ua>

VICOVATION

SIMPLY LIVELY

Vico Power-PLUS⁺

Your Best Smart Car-Battery Power
Management Device!

DC 12v
DC 24v
All-in-one

Instruction
Guide



Autogoods "130"

Index

Attention & Precaution	03
<i>Before installation</i>	04
<i>How it works?</i>	05
<i>Features</i>	06
<i>Package Contents</i>	08
<i>Main product detail</i>	08
<i>Installation Instructions</i>	09
<i>Power-PLUS Menu Configuration</i>	18
– Voltage Setting	
– Hour Setting	
– Temperature Setting	
– About Low-Voltage, Timer and Over-Temperature Protection Coverage	
<i>LED display when engine off (Main Switch under Activate)</i>	26
<i>Main Switch (Activate/Bypass) Function Detail</i>	27
<i>Product Specification</i>	28
<i>Limited Warranty Statement</i>	29

索引

注意事項與重要警語	30
安裝前準備與其他注意事項	31
Vico Power-PLUS 的功能為何?.....	32
特色介紹	33
包裝內容物	35
產品外觀介紹	35
詳細安裝步驟	36
Power-PLUS詳細選單設定說明	43
- 低電壓保護值設定	
- 時間倒數設定	
- 溫度設定	
- 關於低電壓保護/溫度保護/時間倒數關機 設定之作用範圍組合	
引擎熄火後之LED螢幕顯示 (主開關切至Activate啟用)	51
主開關(Activate/Bypass) 功能 與切換說明	52
產品規格	53
售後服務支援	54
免付費維修服務保固說明	55

Attention & Precaution

Power Plus is a power safety device which connects to car battery to work with Dash Cam/Black Box, continuously providing power after engine-off while parking, and monitoring your battery status.

1. Please refer to professional assistance of vehicle original manufacturer/maintenance if you are not able to install by yourself. Vicovation takes no responsibility for incorrect wiring malfunctions by user's mistake/carelessness, or any other damages due to incorrect installing/wiring.
2. Before installing Vico Power-PLUS, please make sure the correct relative pin connection of your car fuse box. Power pin contacts definition might be different depending on different vehicles (Battery+/ACC+/GND).
3. While installing, please be sure to turn off the ignition/engine, to switch your key to "off" position, and take the key out to ensure the power is completely off.
4. After correct installation and wiring, please also check the other electrical equipment are all in normal operation. Incorrect installation (like short-circuit) might lead to damage, fire, electrical shock or traffic accidents.
5. The state of vehicle may affect the performance of the product.
6. Vicovation is not responsible for any install/uninstall costs of the product, regardless the product warranty status.
7. Don't change any fuse to which is not the original rated capacity. Otherwise, a danger of fire exists.
8. Car Battery efficiency may be in big different due to environment (temperature sensitive). Dash Cam operation status may not be constant due to battery performance and external temperature.
9. Vicovation takes no responsibility for car battery life time/warranty.

Before installation

1. Firstly, please diagnose your car battery condition (may be diagnosed by professionals, please refer to original vehicle maintenance) or use electric Multimeter to have basic-check on your car battery voltage status.

Normal Car battery should provide 12.2~12.8V DC with engine-off for 20 minutes, and voltage goes up to 13~14V while engine on (alternator on).

Normal Lead-Acid car battery life-time is averagely about 1~2 years, depending on usage rate, maintenance and environment. If your battery status is not in good health diagnosis, you may consider replacing your battery first. Or the performance of Power-PLUS may be affected.

Besides basic voltage testing, there are some other detail factors relative to car-battery diagnosis, including CA/CCA (cranking amps), loaded voltage...etc. Please go to professionals for detail diagnosis for new battery replacement judged.

2. Check the fuse box definition on car manual and relative instruction, make sure ACC+/Battery+/GND terminals can be installed in correct position.
3. Avoid any short circuit happening while wiring, and also confirm all contacts are in firm position during traffic vibration.
4. When installing/positioning product, please avoid any driving interference. It may cause accidents.

What Vico-Power PLUS can do?

How it works?

“ Vico Power-PLUS

”

Your Smart Car-Battery Power Management Device!

Power-PLUS is a power management device connecting to car battery which working with Dash Cam/Blackbox DVR, continuously providing power after engine-off while parking, and monitoring your battery status. Power-PLUS detects car battery status to cut-off power to prevent car battery from being drained out (discharged).

Together working with **Vicovation Smart Parking Mode** function, your Marcus Dash Cam will enter motion-detection/G-sensor trigger recording after 10mins you left the car, for full parking protection. Unusual events in front of your car will be recorded by motion-detection triggering.

If any unexpected impact occurs, recording can be also triggered by G-Sensor. If there is no motion detection/G-Sensor triggering, Dash Cam stays in standby to save memory space.

Dash Cam will come back to normal recording mode while you start moving your vehicle again (G-Sensor detected). You get full surveillance protection while driving and car parking.

Power-PLUS provides multiple protection to have better safety coverage, including:

1. Low Voltage protection
2. Over Temperature protection
3. Timer protection
4. Over Current/Surge protection

Features



Low Voltage protection:

Power-PLUS will periodically auto-detect your battery voltage status, to cut-off the power if the voltage drops below the configured value (11.6/11.8/12.0/12.2/12.4V or 23.2/23.4/23.6/23.8/24/24.2/24.4/24.6V) to prevent car battery becoming excessively discharged.

Over Temperature protection:

During Summer daytime, inner car temperature raise extremely high if you left your car outside with direct sunlight. Over temperature operation might damage your dash cam. Power-PLUS built-in thermo sensor will cut-off power if temperature exceeded setup value.

(Off /50°/55°/60°/65°/70°/75°C)

*(Off /122°/131°/140°/149°/158°/167°F)



Timer protection:

If you switch into Timer mode, Power-PLUS will cut-off power when time out, based on your setup schedule (2/6/12/24/48/72hrs).



Over Current/Surge protection:

Power-PLUS will detect abnormal over current status and cut-off power to prevent any damage on dash cam device. Additionally, Power-PLUS built in with an extra fuse box (2A), to have extra protection if anything goes wrong as incorrect installing or short circuit.

The Most Perfect Power Device for Smart Parking Mode!

Vicovation Marcus series Dash Cam built in Smart Parking Mode function, providing full protection / continuous recording when car parked.

Power-PLUS is the best companion to enable this continuous monitoring function.



Built-in Digital Display/Backlight LED, easier to monitor/control

Backlight LED enables users to have clear display of car-battery voltage monitoring and setup control, even at night. It's easier to setup configuration with 3 handy control buttons with clear LED friendly display.

Features

Compatible with all kinds of Dash Cam/Car Cam!

Power-PLUS is 100% compatible with all Vicovation production, and also it's compatible with other car cam/black box DVR which equipped standard cigar charger power supply.

Please Note: Other Dash Cam/Blackbox DVR may not include the Smart Paking Mode function.

Multi Input Power Type, DC12V/24V all in one

No matter your car is running DC12V or 24V battery, Power-PLUS will auto-detect the voltage input to display different programmable menu setting. It's automatic.



Multi-Switch to Select Normal mode and Timer mode

Normal mode provides low voltage and over temperature protection at the same time. Timer mode provides original both low voltage and over temperature, also additional timer cut-off when schedule time out. There is a switch on the right side of Power-PLUS for you to switch under different condition.

Programmable Setting, fitting your car environment

Users can select it's own suitable parameter in different cut-off voltage, temperature, and time. It's all clearly displayed in comprehensive menu and friendly user interface.

Main Switch to Select Activate/Bypass for Different Parking Environment/Situation

You may select Power-PLUS power output depending on different parking environment/situation. For example, you may switch to "Bypass" while parking at home garage for saving memory space and car-battery power. And switch to "Activate" while parking outside/unfamiliar place, co-working with Smart Parking mode for parking surveillance.

Switch to Activate: Power-PLUS provides power output to Dash Cam while engine on and also engine off, simultaneously with cut-off protection based on low-voltage/timer/over-temperature.

Switch to Bypass: Power-PLUs provide power output to Dash Cam ONLY when engine on (ACC on). When engine off (ACC off), Power-PLUS provides NO power to Dash Cam.

Package Contents

1. Power-PLUS main product
2. Adhesive Tape
3. Warranty & User's Manual

Main product detail

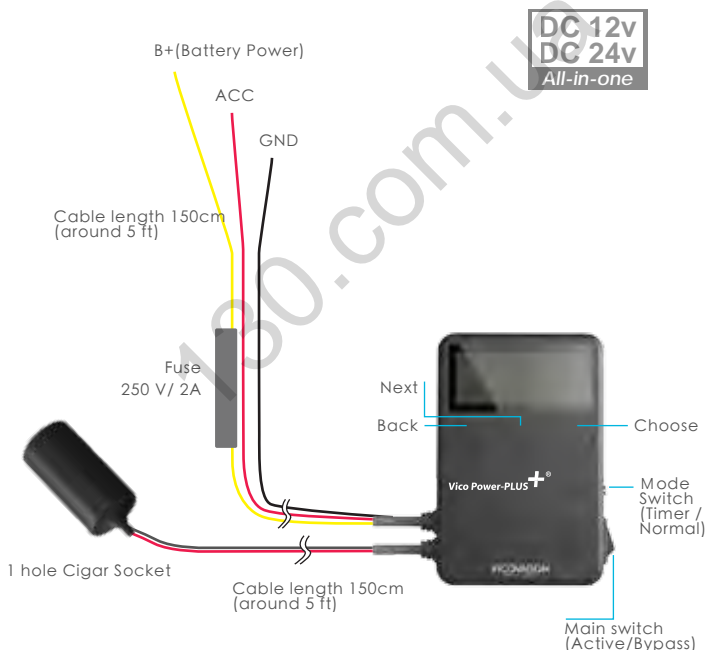

Installation Instructions

STEP 1. Make sure the engine turned off first.

Switch your key to “off” position, and take the key out to ensure the power is completely off.

STEP 2. Make sure Power-PLUS Main Switch turned to “Bypass” location first before installing.

DO NOT switch to Activate before installation finished.

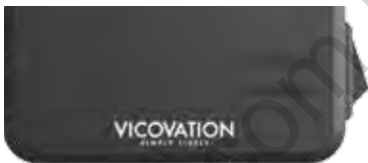

STEP 3. Allocate and open your fuse box.(The location of fuse box may be different from vehicles.)

and check the fuse chart.
Location of ACC+/Battery+/GND may be different from vehicles.



Installation Instructions

STEP 4. Connect the red line (ACC+):

Use multimeter to find out the fuse which provides power **ONLY** after engine turned on, such as audio system (ACC radio), or cigar lighter jack.

Before wiring, make sure your car is completely off (ACC/engine off).

Pull out the fuse to and wire the red ACC+ line together with one of fuse pins (only single pin binding), and **make sure there is no short-circuit between 2-pins of fuse when you insert the fuse back to original position.**

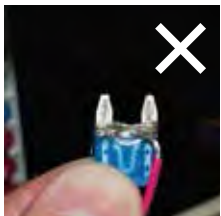

Special Notice:

It's recommended to avoid connecting to high-capacity fuse over 10A (such as 15A/20A/30A). You could wire-binding 5A/7.5A/10A fuses.

Special Notice2:

Again, please refer to professional assistance of vehicle original manufacturer/maintenance if you are not able to install by yourself. Vicovation takes no responsibility for incorrect wiring malfunctions by user's mistake/carelessness, or any other damages due to incorrect installing/wiring.

Special Notice3:

Important!! Do NOT connect to those fuses which relative to car-safety (as TPMS, ABS, Fuel Pump, Air Bag, ALT, ECU, A/T, Brake Light, Front Light, Engine Control, Cooling fan, EBD, TCS, ESP, TRC, SRS, BAS and others), neither critical function (as Car Door, Hazard light, and others).

Special Notice 4:

Instead of fuses located in Car fuse-box, there are other wire/terminals (contacts) on vehicle may also directed to ACC+. You can also modify it with extra fuse adaptor attached and connect it with Power-PLUS ACC+.

STEP 5. Connect the yellow line (Battery+):

Use multimeter to find out the fuse provides permanent power (no matter engine on/off), **such as indoor cab lights, fog lights, door lights, or tail lamp.**

Before wiring, make sure Power-PLUS Main switch located in "Bypass" position. Pull out the fuse to and wire yellow Battery+ line together with one of fuse pins (only single pin binding), and **make sure there is no short-circuit between 2-pins of fuse when you insert the fuse back to original position.**



Special Notice: It's highly recommended to select indoor cab lamp or fog lights in order NOT to affect any driving safety. Please avoid connecting to brake lights, indicator lights, or headlights.

Special Notice2:

It's recommended to avoid connecting to high-capacity fuse over 10A (such as 15A/20A/30A). You could wire-binding 5A/7.5A/10A fuses.

Special Notice3:

Important! Do NOT connect to those fuses which relative to car-safety (as TPMS, ABS, Fuel Pump, Air Bag, ALT, ECU, A/T, Brake Light, Front Light, Engine Control, Cooling fan, EBD, TCS, ESP, TRC, SRS, BAS and others), neither critical function (as Car Door, Hazard light, and others).

Special Notice4: If your car provides "Battery Saver" function, please contact with original car manufacturer/maintenance professionals for more assistance, or consider wiring the yellow line (Battery+) to the fuse of Emergency lamps.

Special Notice5: Please make sure all 3 contacts (B+/ACC+/GND) are correctly connected, or product can't operate normally. And make sure again there is no short circuit happening again.

Special Notice 6:

Instead of fuses located in Car fuse-box, there are other wire/terminals (contacts) on vehicle may also directed to B+. You can also modify it with extra fuse adaptor attached and connect it with Power-PLUS B+.

STEP 6. Connect the black line (GND) for grounding:

Find out the fuse which is connected with device which will be powered **ONLY** after vehicle engine turned on, such as audio system, or cigar lighter jack.

Pull out the fuse to and connect the red ACC+ wire and then insert back together. Make sure there is no short circuit happening.

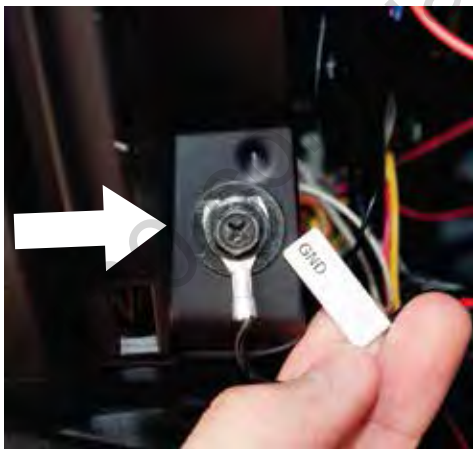

Special Notice:

Some metal snaps on vehicle may have no connection with car metal ground together (like metal snap but connected on plastic parts, no grounding). Use multimeter to ensure it's the real grounding. Incorrect grounding may cause fire or other serious damage.

About Additional Fuse Block Modification

There are multiple types of fuse based on different Cars, including AMP-H/ATP-H/ASP-H/ASM-H/ATP-U/ATP-NS...etc. For wiring B+/ACC connection, you may purchase an extra Fuse Block Add-A-Circuit (Add-a-Circuit Fuse Adapter/Holder kit, as shown below.) for better installation. Make sure your Car Fuse type and you may purchase this kind of Adapter locally for better wiring instead of basic binding wired on one pin of fuse. (This Add-a-Circuit adapter kit is NOT including in the box.)



Notice: Please refer to professional assistance of vehicle original manufacturer/maintenance if you are not able to install by yourself. Vicovation takes no responsibility for incorrect wiring malfunctions by user's mistake/carelessness, or any other damages due to incorrect installing/wiring.

STEP 7. Turn Main Switch into Activate to check:

Car engine stays off (ACC off), and turn the Power-PLUS Main Switch into "Activate". Power-PLUS LED display will show up "Batt" first, and then entering dot cross-blinking display (due to ACC off) afterwards, which is working properly.



STEP 8. Voltage Offset Adjust Calibration:

Car engine stays off (ACC off), use multimeter to check car-battery voltage from fuse box, and calibrate Power-PLUS by Voltage Offset adjust setting.

Long press any button on Power-PLUS for 2 seconds to wakeup from dot-blinking mode. Compare Power-PLUS meter display with your multimeter voltage measuring, and then setup the offset value for better accuracy in voltage-detection. For more detail, please check the Voltage Offset Adjustment pages.

STEP 9. Connect Dash Cam.

Connect the Dash Cam Cigar Charger into the Power-PLUS Cigar socket. And check if the Dash Cam operates normally or not.

Special Notice:

It's commended to use extra tape to fix the connection between cigar charger and Power-PLUS cigar socket, avoiding the detachment/loose due to car vibration.

STEP 10. Start Engine and Double-Check all your Car Electric function:

Important!! Please carefully check ALL your car electric function, including headlight, direction light, break light, hazard, radio...etc. And check if there is any abnormal signal showing from your dashboard display. **Make sure it's 100% working well before your driving. Incorrect installation leads to damages and accidents.**

STEP 11. Configure Power-PLUS menu settings:
You may check the following instruction for more detail and configure your Power-PLUS setting.

STEP 12. Power-PLUS is built-in with thermo sensor, providing over-temperature cut-off protection. Please avoid direct sunlight of Power-PLUS placement. Do NOT place it on the front dashboard or any spot of direct sunlight. Direct sunlight heating might lead to electronic component failure, or abnormal function/failure by incorrect measurement.

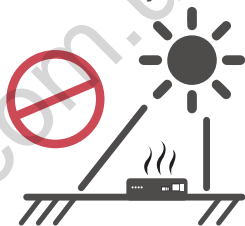

For drive safety, please avoid any view-block while installing Power-PLUS. And avoid any place where might affect your driving control/handling/breaks.

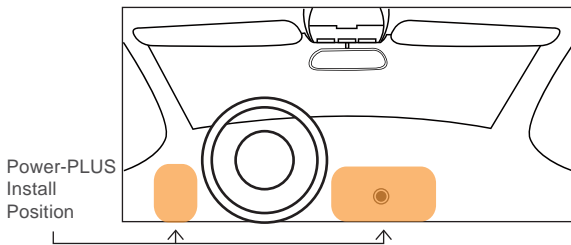

Power-PLUS Menu Configuration

13.2V

- Display Input

29.c

- Display Temp.
Celsius or
Fahrenheit
by choice

Volt

- Display Volt
- Set Low Voltage Protection

Hour

- Display Hour
- Set Timer Protection

TEMP

- Display setting temp.
- Set Temperature Protection
Choose Celsius or Fahrenheit



Go back / Press+Hold 8 sec. will RESET to default



Next option



Enter / Confirm



11.6V ~ 12.4V

default as 12.0V

display previous setting



11.6V.

done setting, an extra point shown.

23.2V. Blink three times



23.2V ~ 24.6V

default as 24.2V



2 hr ~ 72 hr

default as 6 hr

display previous setting



24 hr.

done setting, an extra point shown.

Blink three times



50.c ~ 75.c

default as OFF

display previous setting



55.c.

done setting, an extra point shown.

131.F. Blink three times



122.F ~ 167.F

default as OFF



After staying at this menu for 15 seconds (time out), it will display Input

Power-PLUS Menu Configuration



Go back / Press+Hold 8 sec. will RESET to default



Next option



Enter / Confirm

OFst

- Voltage
Offset
Calibration



-0.5V ~ 0.5V
default as 0 V

display
previous
setting



0.1V

done setting, an
extra point
shown. ✓

Blink three times

rBot

- Set ACC
Restore
Reboot



Act / OFF
default as Act

display
previous
setting



OFF.

done setting, an
extra point
shown. ✓

Blink three times

13.2V

- Display
Input

29.c

- Display Temp.
Celsius or
Fahrenheit
by choice

After staying at this menu
for 15 seconds (time out), it
will display Input Voltage.

Voltage Setting(Low Voltage Cut-off Setting)



Voltage setting determines the low voltage value of cut-off threshold. Default setting is 12.0V DC. If Car battery goes lower than 12.0V, Power-PLUS will cut off power output to Dash Cam (Car DVR) to prevent Car Battery from being drained out (discharged).

You may setup the threshold based on car battery status. Setup values include: 11.4/11.6/11.8/12.0(default)/12.2/12.4/12.6V.

Under battery mode, when voltage lower than threshold longer than 30 seconds, Power-PLUS will cut off power output.

How to setup Low Voltage value fits my car?

Please use Multimeter to check your car battery voltage while engine-off without Dash Cam loaded first (engine off for 5~10mins, without car alternator affected).

And then, measure the second voltage with Dash Cam working-loaded while engine-off (you may connect Dash Cam to Cigar Charger).

For example, Multimeter detects 12.5V in car battery without Dash Cam loaded. And check again with Dash Cam loaded (plug into Cigar Charger with ACC ON, but engine stays OFF), Multimeter may detects 12.2V when Dash Cam loaded (working/recording). So you may setup your Low Voltage setting in 12.0~11.8V. At least 0.2V lower than DashCam-loaded voltage measured is needed.

Power-PLUS has Multi-input type, including DC12V and DC24V. Power-PLUS will auto-detect your car voltage to display different programmable setup value automatically. If your car is DC24V type, setup value will be 23.6/23.8/24/24.2(default)/24.4/24.6V.

Low Voltage Protection works in both Normal and Timer Mode, while Main Switch turns on (Activate) with ACC off when car parking.

Power-PLUS display shows up "LoVT" for indicating power output disable based on low voltage happening.



Autogoods "130"

Special Notice & Self-Checking:

Make sure your low voltage threshold value suits your car battery status, otherwise Dash Cam (Car DVR) might keep rebooting (when car-parking) due to Power-PLUS error behavior by wrong setup.

Please make self-checking after Power-PLUS installed, to make Power-PLUS working together with Dash Cam (Car DVR). Make sure engine off for 5~10mins without alternator affected.

Stay for a while during parking (ACC off) to see if Dash Cam operating normally or not (Power-PLUS detects and cut off power after 30 seconds low voltage happened). Once you found your Dash Cam keep rebooting during parking (ACC off), you may check your low voltage setting. It may setup too-high threshold, and you can lower down the setup value for modification.

If rebooting keeps happen, please go to professional battery diagnosis for checking your car battery health status (CA/CCA), to check if car battery needs to be replaced or not.

Hour Setting



Hour Setting determines the time-out schedule while you switch into Timer Mode. Power-PLUS will cut off power output based on countdown from engine off.

Default setting is 6 hours, and if you select the mode switch into Timer Mode, Power-PLUS will cut off power output after 6 hours of engine-off (ACC off), OR Car Battery voltage reach the cut-off threshold, OR environment temperature exceed setup value.

You may select 2/6/12/24/48/72 hours.

Power-PLUS display shows up "TIME" for indicating power output cut-off based on timer countdown finished.



Temperature Setting



Temperature Setting determines the over-temperature cut-off protection threshold. Default is off. You may setup different value depending on your location climate. During summer time, if outside temperature is over 35°C (95°F), it might be over 70°C (158°F) in car without air-conditioner when parking outside under sunlight. You may setup your temperature threshold value based on parking environment.

Special Notice: Please avoid Power-PLUS placement under direct sunlight. Or it might lead to electronic component failure, or abnormal function/failure by incorrect measurement.

You may select 50°C/55°C/60°C/65°C/70°C/75°C or 122°F/131°F/140°F/149°F/158°F/167°F.

It's recommended to setup 55-60°C/131-140°F firstly and observe the following temperature change after parking, for better adjusting your setting. Over-temperature operation might lead to SD card failure or Dash Cam crash.

It's recommended to have max temperature only up to 65°C/149°F, since SDHC/SDXC memory card may not able to working/recording under too high temperature for a long time.

Power-PLUS display shows up "OVTP" for indicating power output cut-off based on Over Temperature. As below:



Notice: Temperature measured by Power-PLUS might be a little different from Vehicle thermometer due to different thermo-sensor position. Temperature shown on Power-PLUS is for reference only. User may setup over-temperature cut-off gate based on different vehicle environment.

About Low-Voltage, Timer and Over-Temperature Protection Coverage:

When Main Switch in Activate position, Power-PLUS provides different protection Coverage based on your Mode Switch setting.

Timer Mode Coverage:

Power-PLUS provides low-Voltage protection, over-temperature protection, and time countdown at the same time while car parking. If any parameter reach the threshold value of these 3 protection, Power-PLUS will auto cut-off power output to Dash Cam/Car DVR.



Normal Mode Coverage:

Power-PLUS provides low-Voltage protection and over-temperature protection at the same time while car parking. If any parameter reach the threshold value of these 2 protection, Power-PLUS will auto cut-off power output to Dash Cam/Car DVR.

Voltage Offset Function Detail

Voltage Offset Adjustment:



Power-Plus voltage detection might have slight shift due to component/SMT manufacturing, you may benchmark voltage value on standard multimeter to setup calibration in menu setting. There are +0.1/0.2/0.3/0.4/0.5v and -0.1/-0.2/-0.3/-0.4/-0.5v parameter for setting.

Use multimeter to check your car battery voltage while engine off (engine off for 5~10mins). And compare with Power-PLUS voltage display.

For example, if multimeter detects with 12.5V, but Power-PLUS shows 12.4V, you have to setup +0.1V in Power-PLUS for calibration. +0.1V offsets Power-PLUS from 12.4V into 12.5V.



If multimeter detects with 12.5, but Power-PLUS shows 12.6V, you have to setup -0.1V in Power-PLUS for calibration. -0.1V offsets Power-PLUS from 12.6V into 12.5V.



ACC Restore Reboot Function Detail

ACC Restore Reboot Function:

Activate the ACC Restore Reboot function will reboot Power-PLUS output for Dash Cam-rebooting when ACC status turn-on from ACC-off. Power-PLUS keep providing power output to Dash Cam while ACC turns into OFF (engine off). When ACC turns ON (engine ON), Power-PLUS is able to program for power reboot or not.

Default setting is "Act." (Activate):
Power-PLUS's Power output to Dash Cam will reboot while engine (ACC) restart, leading Marcus Car DVR reboot itself due to power on-> off -> on.

If you set into "Off":
Power-PLUS will keep providing power continuously no matter ACC on/off switching. Marcus Car DVR stays turn on, no rebooting if ACC back to ON.



Suggestion:

Activation of this function is recommended. Initializing/rebooting Dash Cam every time you coming back to vehicle allows Dash Cam to have initial checking while boot up. Users may also have better notification with Dash Cam status with booting sounds and error message appearing if any, for having better awareness of Marcus status.

LED display when engine off (Main Switch under Activate)

Timer Mode

After engine off (ACC off), Power-PLUS LED display will show BATT (Battery Power) for 3 seconds.



After 3 seconds, LED display will enter sleeping mode, only cross-blinking semicolon 2 dots (in center part) repeatedly, shown as below.

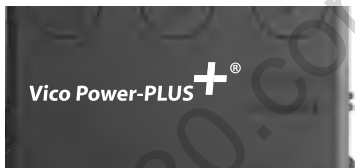

Normal Mode

After engine off (ACC off), Power-PLUS LED display will show BATT (Battery Power) for 3 seconds.



After 3 seconds, LED display will enter sleeping mode, only cross-blinking last 2 dots (decimal point at bottom side) repeatedly, shown as below.



Main Switch (Activate/Bypass) Function Detail

Bypass

When main switch change to “Bypass”, Power-PLUS function turns off.

While engine on (ACC ON), Power-PLUS still provides power to Dash Cam/Car DVR.

While engine off, Power-PLUS stops providing power output. Dash Cam/Car DVR turns off.

If you will leave your car parking for a long period (over 7 days), we recommend you to switch into Bypass, or you may setup Timer mode for limited hours operation.



Activate

When main switch stays in “Activate”, Power-PLUS function turns on.

While engine on (ACC ON), Power-PLUS provides power to Dash Cam/Car DVR. While engine off, Power-PLUS keeps providing power to Dash Cam/Car DVR for Smart Parking Mode (Power from Car Battery), and also monitoring your car battery status (Low Voltage protection) and environment temperature (Over Temperature protection), or Timer cut-off countdown if you switch Normal/Timer mode switch into Timer Mode.

Product Specification

Input interface	Positive (B+) Yellow (with B+ tag) ACC Red (with ACC tag) GND Black (with GND tag) Cable length 150cm(around 5 ft)
Output interface	1 hole Cigar Socket Cable length 150cm(around 5 ft)
Fuse	Located on B+ (250V/2A)
Input	12~24v (Car Battery Power)
Rated Output Voltage	12~24v
Output Current	Rated Current 1A, Max 2A
Standby Current (Leakage Current)	Below 100 μ A (0.1mA)
Voltage Offset Adjustment Setting	0.1/0.2/0.3/0.4/0.5/-0.1/-0.2/-0.3/-0.4/-0.5v 11.4v ~ 12.6v (+0.1V)
Cut-off Voltage Setting (input)	11.4 / 11.6 / 11.8 / 12.0(default) / 12.2 / 12.4 / 12.6 23.2v ~ 24.6v (+0.1V) 23.2 / 23.4 / 23.6 / 23.8 / 24 / 24.2(default) / 24.4 / 24.6
Output Recovery Voltage (Restoration)	Cut-off Voltage +0.2v or more Act./Off
ACC Restore Reboot	2 / 6 / 12 / 24 / 36 / 48 / 72 hrs
Output Cut-off Timer Setting	Off /50° /55° /60° /65° /70° /75° C Off /122° /131° /140° /149° /158° /167° F
Over Temp. Cut-off Setting (Celsius or Fahrenheit)	Cut-off Temp -5°
Output Recovery Temp. (Restoration)	-20°C~ 75°C (-4° F~167° F)
Operation Temp.	Low Voltage Protection Temperature Protection Timer Protection Over Current/Surge Protection
Protection	Activate/Bypass Main Switch Normal/Timer Mode Switch Menu/Select/Ok key
Control Key and Switch	Autogoods "130"

Limited Warranty Statement

1. The limited warranty of main device is twelve (12) months from the date of original purchase. The valid original invoice (PROOF OF PURCHASE) will be required.
2. The limited warranty is valid in the countries where this products is sold. Please contact with the reseller (or on-line shop) who sold this unit for detailed in-warranty service.
3. The warranty does not apply to the damage which occurs in shipment or failure results from accident, misuse, abuse, water, fire, other acts of nature, external causes, or faulty installation.
4. Disassembly of the unit might cause damage and makes it out of warranty.

Any question, please dont hesitate to contact

Email: Service@vicovation.com

Facebook: www.Facebook.com/VicoVation



Line: Vicovation



注意事項與重要警語

1. 安裝視連科Power-PLUS產品，需要拆裝汽車內車用保險絲。若無法自行安裝，強烈建議委託專業汽車維修人員，或汽車原廠技師處理。若因不當安裝造成車輛損毀故障或是人員傷亡，本公司一概不負責。
2. 安裝前請先確認車用保險絲盒的位置，以及車用保險絲的定義。請參考汽車手冊，或是保險絲盒蓋參考圖。每個車種的保險絲定義皆不同，請確認Battery+/ACC+/GND此三個接點。
3. 安裝時，請務必將引擎熄火，關閉車輛電路，並將鑰匙拔除，確保電源為完全關閉狀態。
4. 安裝完成之後，請確認其他車用電氣設備是否皆正常運作。不正常的安裝與不正常狀態之連續使用可能導致起火，短路，電擊，或是交通事故，請務必注意。
5. 不同車輛的狀態與環境可能會影響產品的效能表現。
6. 視連科不負責Power-PLUS的安裝與拆卸，無論產品的保固期狀態。
7. 請勿自行更換任何車用保險絲(規格載量)，否則可能導致起火或是其他危險。
8. 車用電瓶的電壓狀態與表現與環境溫度有關，行車記錄器的停車監控維持狀態時間也可能會跟著變化。
9. 視連科不負責任何車用電瓶(電池)之壽命或保固服務。

電力加-安裝前準備與其他注意事項

1. 首先，請先檢查車用電瓶狀態(建議委託專業汽車維修人員，或原廠技師檢查)。使用電表檢查電瓶電壓狀態，正常電瓶應該具有12.2~12.8V電壓(引擎熄火20分鐘後之量測)，引擎發動之後應該有13~14V。一般車用鉛酸電池壽命約為1~2年，依使用狀況與環境而不同。若您的電瓶狀態不良，建議先行更換車用電瓶，再安裝使用Power-PLUS，否則產品的表現將會受到影響。

汽車電瓶檢測除了電壓提供基本參考之外，還有其他相關檢測項目，如啟動電流(CA/CCA)與負載電壓，可能需要專業車廠汽車維修人員使用專業器材檢查，才能完整診斷汽車電瓶健康狀態。

2. 務必確認車用保險絲的位置與相關定義，確認相對之 Battery+ / ACC+ / GND 接點。更多說明請參考本冊之安裝步驟。
3. 安裝時請務必避免任何接線短路發生，並且穩定與固定接點連接，避免車輛振動產生脫落，導致故障或其他危險發生。
4. 安裝Power-PLUS的主機固定位置時，請避免影響行車視線，或影響行車操控，以免發生危險。

電力加- 的功能為何？

“ Vico Power-PLUS，您的最佳
智慧車輛電力監控模組。 ”

Power-PLUS是一個車輛電力監控保護裝置，與車用電瓶連接後，可在引擎熄火之後持續供電給行車記錄器，提供停車監控功能使用。同時監控電瓶電壓狀態，電壓過低自動斷電，避免電量過度消耗而無法發動引擎。

搭配啟動視連科獨家智慧停車監控功能(Smart Parking Mode)，行車記錄器主機會自動偵測車輛停車狀態(十分鐘靜止之後)，自動進入停車位移偵測模式。攝影機前方的事件都可以被記錄下來(位移偵測觸發Motion Detection)，同時也可以被碰撞觸發錄影(G-Sensor)。若沒有任何事件發生，攝影機則是維持休眠模式，簡省記憶卡儲存空間。當您回到車上發動引擎，G-Sensor偵測到車輛位移或是振動，行車記錄器則回到正常錄影模式。Power-PLUS加上視連科智慧停車監控功能，提供您最完整的行車/停車安全保護。

Power-PLUS 提供完整全面的保護功能，包含：

1. 低電壓斷電保護
2. 溫度過高斷電保護
3. 計時斷電保護
4. 大電流與突波電流保護

電力加-特色介紹



低電壓斷電保護

Power-PLUS會持續偵測車用電瓶電壓狀態，當電壓低於設定值，自動斷電保護。設定電壓值可自行調整：11.4/11.6/11.8/12.0/12.2/12.4V 或23.2/23.4/23.6/23.8/24/24.2/24.4/24.6V (一般車輛為DC12V，Power-PLUS會自動偵測12/24V，顯示不同設定。) 建議設定值不低於

溫度過高斷電保護

夏日炎熱高溫，若車輛放置室外陽光直射，車內溫度過高可能導致電器設備損壞。

Power-PLUS內建溫度感測器，當溫度高於設定值，自動斷電保護。設定溫度值可自行調整：50° /55° /60° /65° /70° /75° C 攝氏，或104° F / 113° F / 122° F / 131° F / 140° F / 149° /158° /167° F華氏。預設



停車計時斷電保護

若將開關切換至Timer Mode，車輛熄火之後，Power-PLUS會依照時間設定值倒數計時，時間到了之後會自動斷電。時間設定值可自行調整：2/6/12/24/48/72hrs.



大電流與突波電流保護

Power-PLUS除了電壓過低斷電保護之外，在主要的接線上 (Battery+)有裝置額外的保險絲盒，內有2A的保險絲，提供異常短路可能產生的大電流保護。

Smart Parking Mode智慧停車監控的最佳拍檔！

視連科Marcus系列行車記錄器透過新版軟體升級，具有智慧停車監控功能，搭配安裝視連科電力加Power-PLUS，提供最完整的行車/停車安全監控保護。



內建背光LED面板，顯示清晰，操作得心應手！

紅色背光LED螢幕具有更好的清晰顯示，無論白天黑夜，電壓監測與操作設定皆可清晰顯示。

電力加-特色介紹

除了視連科，也與其他各種行車記錄器相容
Power-PLUS除了完全兼容視連科行車記錄器產品系列，同時也兼容其他使用車充電源線(點煙器車充頭)之行車記錄器使用。請特別注意：其他行車記錄器不一定具備停車監控模式(位移偵測)，或是需要停車之後手動切換。

DC12V/24V雙模，各種車輛都可使用
無論你的愛車是標準DC12V電壓，或是重型卡車DC24V，Power-PLUS皆可支援使用。
Power-PLUS會自動偵測輸入電壓，選單顯示不同的斷電電壓參數設定值。



模式切換鈕，輕鬆切換一般(Normal)或計時斷電(Timer)模式
一般模式(Normal)同時提供低電壓與溫度過高斷電保護，而計時斷電模式除了提供同時提供低電壓與溫度過高斷電保護之外，還可依照設定時間倒數計時自動斷電。側邊的切換鈕可依照不同需求輕鬆切換使用。

多種設定參數可選，可依照車況與環境調整設定
使用者可自行設定不同的斷電電壓值，溫度設定值，與計時斷電時間設定值。可以依照不同的車況與環境來客製化調整適合自己愛車的設定參數。

主開關切換鍵，可依不同停車環境切換熄火供電與否，動態節省電瓶電力，自由開關

可依停車環境切換Power-PLUS供電狀態，例如，停車於自家車庫或較安全環境時，可切至Bypass，節省記憶卡容量與車用電瓶電力。停車在外或不熟悉的環境，則可切至Activate搭配Smart Parking Mode停車監控使用。

切至Activate(開啟)：引擎發動(行駛)時正常供電給行車記錄器，也會在停車熄火(停車)的狀態下持續供電，與提供斷電保護。

切至Bypass(關閉)：引擎發動(行駛)時正常供電給行車記錄器，停車熄火後則停止供電，行車紀錄器關機。

電力加-包裝內容物

1. Power-PLUS主產品。
2. 雙面背貼。
3. 使用手冊。

電力加-產品外觀介紹

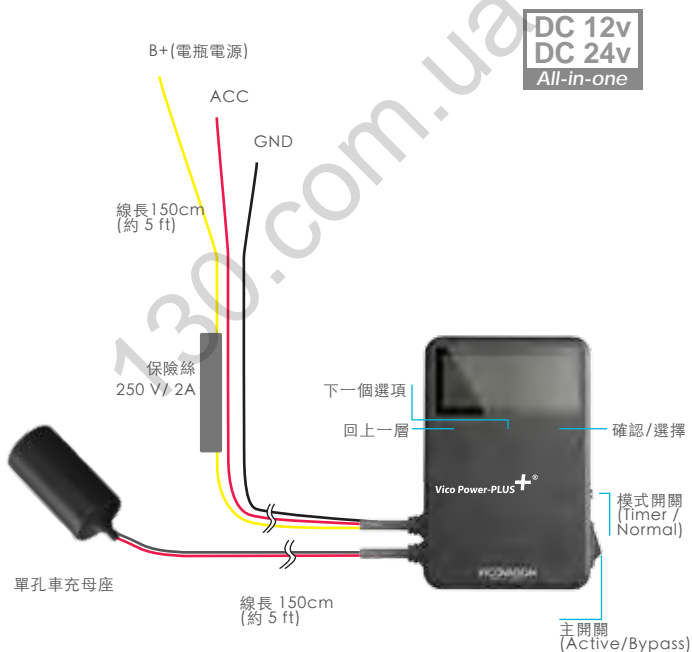

詳細安裝步驟

步驟 1. 拔除車鑰匙，確認愛車完全熄火。(Engine off/ACC off)。

步驟 2. 安裝前，請確認Power-PLUS主開關切至” Bypass” 位置。安裝完成之前請勿切換至” Activate” 。



步驟 3. 先確認愛車車內的保險絲盒位置(不同車種保險絲盒的位置不一樣)

請先參考汽車手冊或是保險絲配置圖，打開保險絲盒之後，先確認ACC+/Battery+/GND接點相對位置。(相對應接點定義請參考下面各個步驟詳細說明。)



步驟 4. 連接紅色ACC+接線：

安裝前，再次確認您的愛車完全熄火(engine/ACC off)
。找出相對應ACC+保險絲，利用三用電表找出：只有汽車引擎開啟時(ACC ON)才供電的保險絲(確認引擎關閉時不供電)，像是音響設備，或是點煙器。

拔出該保險絲，將紅色ACC+線接上保險絲的其中一個接腳，再將保險絲插回原座。請特別注意接線狀況，避免任何短路發生。請勿同時纏繞保險絲的兩支接腳造成短路。



特別注意一：

若無法自行判斷安裝，建議委託專業汽車維修人員，或汽車原廠技師處理。若因不當安裝造成車輛損毀故障或是人員傷亡，本公司一概不負責。

特別注意二：

建議使用較低安培數的保險絲，(像是5A/7.5A/10A)，避免使用高電流數的保險絲(如15A/20A/30A)。

特別注意三：

重要！請勿連接使用與行車安全相關電器的車用保險絲，如：安全氣囊，胎壓偵測，行車電腦，循跡系統，煞車燈，車頭燈，ABS，Fuel Pump, ALT, ECU, A/T, , Engine Control, Cooling fan, EBD, TCS, ESP, TRC, SRS, BAS 與其他重要功能，如：車門鎖，警示燈與其他。

特別注意四：

除了保險絲盒內的保險絲接點之外，車廂內電器系統有其他相對應的ACC+接點，您也可以另外自行加裝保險絲來從其他ACC+接點延長，連接至Power-PLUS 紅色ACC+接線。

步驟 5. 連接黃色Battery+（永久正）接線：

找出相對應Battery+保險絲，利用三用電表找出：汽車引擎關閉時仍供電的保險絲(確認引擎開啟與關閉時皆全時供電)，像是車內閱讀燈，車門燈，霧燈或車尾燈。安裝前請先確認Power-PLUS主開關切至”Bypass”位置。拔出該保險絲，將黃色B+線接上保險絲的其中一個接腳，再將保險絲插回原座。請特別注意接線狀況，避免任何短路發生。請勿同時纏繞保險絲的兩支接腳造成短路。安裝時請確認引擎熄火。



特別注意：

因為行車安全考量，請避免連接至煞車燈，方向燈，車前大燈，警示燈。建議接至車內燈，車門燈。

特別注意二：

建議使用較低安培數的保險絲，(像是5A/7.5A/10A)，避免使用高電流數的保險絲(如15A/20A/30A)。

特別注意三：

重要！請勿連接使用與行車安全相關電器的車用保險絲，如：安全氣囊，胎壓偵測，行車電腦，循跡系統，煞車燈，車頭燈，ABS，Fuel Pump, ALT, ECU, A/T, , Engine Control, Cooling fan, EBD, TCS, ESP, TRC, SRS, BAS 與其他重要功能，如：車門鎖，警示燈與其他。

特別注意四：

若您的愛車具有智慧節電功能，才需考慮是否將B+接至警示燈，或請教原廠專業人員建議，請特別留意。

特別注意五：

確認三個接點(B+/A+/GND) 都正確安裝無誤，避免任何短路發生，並確認接點穩固連接，不受車輛行進間振動影響而脫落，否則可能造成故障/起火，或是危險事故發生。

特別注意六

除了保險絲盒內的保險絲接點之外，車廂內電器系統有其他相對應的B+(永久正)接點，您也可以另外自行加裝保險絲來從其他B+接點延長，連接至Power-PLUS 黃色B+接線。

步驟 6. 連接黑色GND接地線

:

將黑色GND接地點接至車體金屬部分，或是專用接地鎖點進行接地。使用三用電表來確認接地點為正確接地接點。(可能金屬螺帽鎖點接至塑膠機構上而絕緣無接地，需要電表正確量測判斷。) 不正確的接地可能導致火花或是其他損壞發

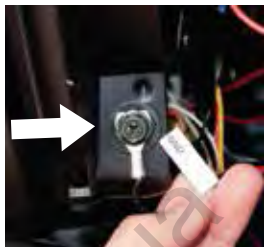

有關車用保險絲擴充改裝

除了基本的纏繞接線方式之外，也可另外自行購買延長型車用保險絲擴充線座(如圖) (Add-a-Circuit Fuse Adapter/Holder kit)來延長安裝。不同的車輛有不同的保險絲種類規格，包含 AMP-H/ATP-H/ASP-H/ASM-H/ATP-U/ATP-NS...等。可依照



若無法自行安裝，強烈建議委託專業汽車維修人員，或汽車原廠技師處理。若因不當安裝造成車輛損毀故障或是人員傷亡，本公司一概不負責。

步驟 7.將Power-PLUS主開關切至Activate啟用與檢查：

車輛依舊保持完全熄火狀態(ACC off)，將Power-PLUS主開關切至” Activate” 啟用，LED螢幕會先顯示” Batt”，然後進入雙點閃爍顯示，如此表示安裝正確。



步驟 8.電壓顯示校正：

車輛保持完全熄火狀態，使用三用電表量測車用電瓶的電壓值，來校正Power-PLUS所顯示的電壓值誤差。長按Power-PLUS任意鍵兩秒鐘喚醒，切至電壓顯示，對照三用電表所量測出的正確電壓值，來微調Power-PLUS所量測的電壓值。詳細設定與說明請參考電壓顯示校正頁面。

步驟 9.連接行車記錄器：

將行車記錄器的車充電源線接至Power-PLUS的車充母頭，確認行車記錄器正常開機錄影使用。

特別注意：

建議使用電器膠帶將車充線與Power-PLUS車充母座結合固定，避免車輛行駛振動而鬆脫。

步驟 10.發動引擎，並完整確認汽車所有電器設備功能一切正常。

非常重要！請務必仔細確認所有車上的電器設備功能正常無異，包含車頭燈，方向燈，煞車燈，警示燈，車內音響，與所有其他電器系統，確認儀表板沒有任何錯誤警示燈號亮起，開車上路之前請務必確認安裝沒有影響至任何行車安全。錯誤的安裝可能導致損壞或是意外發生，若因不當安裝造成車輛損毀故障或是人員傷亡，本公司一概不負責。

步驟 11.設定Power-PLUS主機各項參數設定：
請參考設定選單說明頁面，調整適合您愛車環境的設定值。

步驟 12.

Power-PLUS 內建溫度感測器，提供溫度過高斷電保護功能，請避免將

Power-PLUS主機裝置在車內陽光直射的位置，例如：儀表板上方。避免陽光直射造成電子零件的損壞，或是錯誤的溫度判斷造成功能異

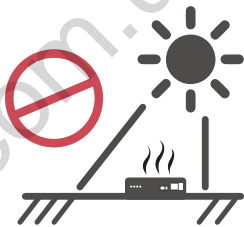

請避免將Power-PLUS主機裝置在任何阻擋行車視線的位置，或是任何影響行車操控的位置，影響行車安全，請特別注意。

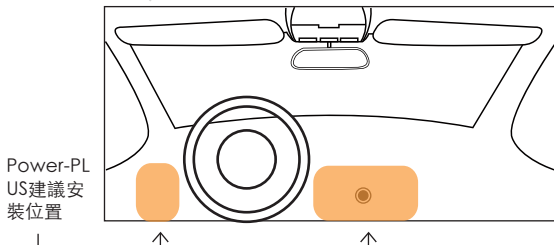

電力加-詳細選單設定說明

13.2V

- 顯示輸入電壓

29.c

- 顯示目前溫度
- 顯示攝氏或華氏



回到上一層 / 長按8秒回復預設值設定



下一個選項



確認選取

Volt

- 顯示 Volt
- 設定斷電電壓



11.6V ~ 12.6V

預設值為12.0V

顯示前次設定



11.6V



設定完成，最後面顯示多一點
同時顯示閃爍三次

23.2V

Hour

- 顯示 Hour
- 設定斷電時數



2 hr ~ 72 hr

預設值為6hr

顯示前次設定



24 hr.

設定完成，最後面顯示多一點
同時顯示閃爍三次

TEMP

- 顯示 temp
- 設定斷電溫度



50.c ~ 75.c

預設值為OFF

顯示前次設定



55.c.





設定完成，最後面顯示多一點
同時顯示閃爍三次

131.F.

- 可自行選擇攝氏或華氏

若停在這顯示15秒後
(time out)，跳回顯示電壓

電力加-詳細選單設定說明

-  回到上一層 / 長按8秒回復預設值設定
-  下一個選項
-  確認選取

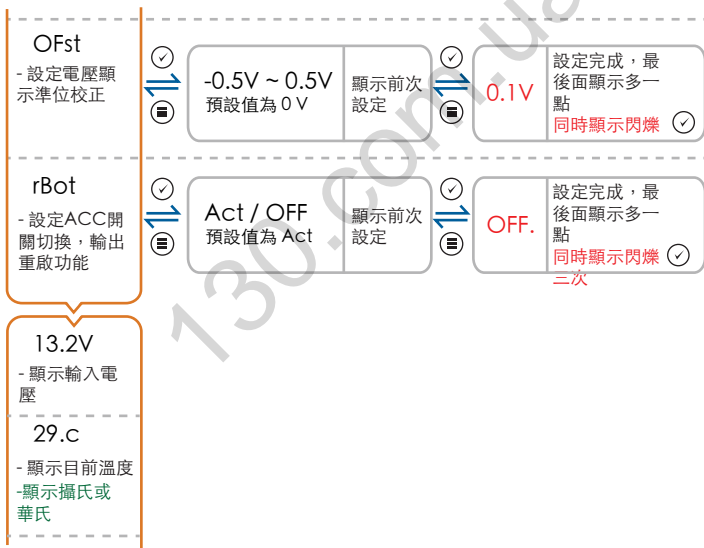

若停在這顯示15秒後
(time out)，跳回顯示電壓

低電壓保護值設定



電壓設定決定低電壓斷電保護的門檻值，當電瓶電壓低於此設定值，Power-PLUS會自動啟動斷電保護，避免電瓶過度放電而無法啟動引擎。預設值為12.0V。可依照不同車輛與電瓶狀況調整。

設定值範圍：11.4/11.6/11.8/12.0(預設)/12.2/12.4/12.6V。

當電力加偵測到電壓低於設定值三十秒後，電力加會啟動斷電保護。

如何設定符合自己愛車的低電壓設定值？

使用三用電表量測電瓶電壓(引擎熄火十分鐘)，先量測沒有安裝行車紀錄器(負載)的情況下的電瓶電壓，再量測安裝行車紀錄器開機錄影之後的電壓值(引擎保持熄火狀態)，根據您愛車電瓶的負載電壓值來設定。

舉例而言：首先電表量測出12.5V(引擎熄火十分鐘，沒有安裝行車紀錄器)，然後再接上行車紀錄器開機錄影(引擎保持熄火)，量測出電壓為12.2V(電瓶電壓因接上負載而降低)，可設定低電壓保護值於12.0~11.8V。至少需0.2V低於負載電壓值(行車紀錄器開機錄影)。

Power-PLUS具備DC12V與24V雙模功能，會自動偵測汽車電壓，根據不同電壓模式顯示不同的設定值。若您的愛車為DC24V，顯示設定值則會自動變更為：23.6/23.8/24/24.2(預設)/24.4/24.6V。

主開關切至啟動(Activate)，於停車狀態下(ACC Off)，低電壓保護功能同時在Normal與Timer模式底下作用，當電壓過低時提供斷電保護。

主開關切至啟動(Activate)狀態下，低電壓保護功能則起作用在

當電壓過低而斷電保護時，
Power-PLUS螢幕會顯示
"LoVL"，提示電壓過低狀態。



Autogoods "130"

特別注意與自我檢測：

請確認您的低電壓保護設定值符合您的愛車電瓶狀態，否則在停車狀態下，可能會因為錯誤的設定值讓您的行車記錄器出現反覆重開機的狀況。

電力加安裝完畢後，請自行檢查，於停車引擎熄火十分鐘之後，開啟電力加與行車記錄器開機錄影使用。若是您的設定值過高，可能會因為接上負載而電壓過低造成斷電行車記錄器關機，而關機又讓負載解除而電壓上升，於是電力加又重新輸出電源而行車記錄器開機，又因接上負載而壓降造成電壓過低斷電...變成反覆重開機現象的錯誤迴圈狀態。

如果發生這個現象，請降低您的低電壓設定值。如果還是反覆發生，可能需要返回汽車原廠/保養廠進行汽車電瓶檢測，使用專業器材檢測您的愛車電瓶的健康狀態(CA/CCA)，確認電瓶是否需要換新。

時間倒數設定



當模式開關切換至時間計數模式底下時，時間倒數設定值決定引擎熄火後Power-PLUS自動斷電之時間。

舉例而言，預設值為六小時，若您切至時間計數模式(Timer Mode)，引擎熄火六小時之後Power-PLUS會自動斷電。在這段期間，若電壓先出現過低(低於低電壓保護設定值)，低電壓保護也會自動斷電。同時若是溫度過高(高於溫度保護設定值)，過溫保護也會自動斷電。

可選擇2 / 6 / 12 / 24 / 48 / 72 小時。

當時間倒數完畢而斷電保護時，Power-PLUS螢幕會顯示” TIME”，提示倒數關閉狀態。



溫度設定



當停車溫度高於此設定值時，Power-PLUS會自動斷電保護。預設值為關閉(off)請依照停車之環境溫度來設定。炎熱夏天，若室外溫度到達35° C，停在戶外陽光下的車內溫度可能已經超過70° C。建議首先可先行設定為55-60° C，之後再觀察停車之後回到車上，在Power-PLUS上所顯示的溫度狀況，再進行微調。

特別注意：請留意Power-PLUS的車內安裝位置，避免陽光直射而造成電子零件損壞或錯誤的溫度量測而造成功能不良。

選擇可設定攝氏

50° C/55° C/60° C/65° C/70° C/75° C 或是華氏
122° F/131° F/140° F/149° F/158° F/167° F.

由於記憶卡SDHC/SDXC無法於高溫環境下長時間工作(檔案寫入儲存)，建議溫度保護最高設定值不超過65° C，可減少記憶卡因高溫工作而造成損壞之風險。

當溫度過高而斷電保護時，Power-PLUS螢幕會顯示
”OVTP”，提示溫度過高關閉狀態。



注意：因為溫度感測元件位置不同，電力加主機顯示溫度可能與汽車溫度計顯示有些許差異。電力加並非專業型電子溫度計，所顯示溫度值僅供輔助參考，使用者可依照不同的車輛使用環境來設定溫度過高斷電保護值。

關於低電壓保護/溫度保護/時間倒數關機設定之作用範圍組合

當主開關切至啟動(Activate)，Power-PLUS根據您的模式開關(Mode Switch)設定而提供不同保護組合。

時間計數模式(Timer Mode)組合：

當模式開關切至時間計數模式，Power-PLUS同時提供低電壓偵測保護，溫度過高保護，與時間倒數完畢自動斷電功能。當任何一個參數值超過設定門檻值(溫度過高，電壓過低或是倒數完畢)，Power-PLUS會自動斷電保護，行車紀錄器關機。



正常模式(Normal Mode)組合：

當模式開關切至正常模式，Power-PLUS同時提供低電壓偵測保護與溫度過高保護。當兩者當中，任一個參數值超過設定門檻值(溫度過高或電壓過低)，Power-PLUS會自動斷電保護，行車紀錄器關機。

電壓顯示準位校正(Voltage Offset Adjustment):

電壓顯示準位校正



Power-PLUS電力加之電壓偵測顯示可能會因為生產過程有微小誤差，可使用標準三用電表來對照量測值與微調Power-PLUS的偵測準位。設定範圍有+0.1/0.2/0.3/0.4/0.5V 與-0.1/-0.2/-0.3/-0.4/-0.5V可供調整選擇。

請將愛車熄火，使用標準三用電表量測車上電瓶接點電壓(請熄火五～十分鐘)，對照Power-PLUS電壓顯示，例如：三用電表量測為12.5V，Power-PLUS顯示為12.4V，請選擇+0.1V來將微調電壓準位。+0.1V設定值會將



+



↓



例如：三用電表量測為12.5V，Power-PLUS顯示為12.6V，請選擇-0.1V來將微調電壓準位。-0.1V設定值會將Power-PLUS 偵測顯示由12.6V改為12.5V。



+



↓



ACC開關切換，輸出重啟功能：

開啟ACC開關切換重啟功能，停車後當您返回車上重新發動引擎之後，Power-PLUS電源供應輸出會重啟一次，讓搭配的視連科行車記錄器也重新啟動一次。如果關閉此功能，無論引擎是否重新啟動，Power-PLUS則是維持供電狀態。

預設值為” Act.” (Activate啟用)：

當您返回車上重新發動引擎，Power-PLUS電源輸出會重新啟動一次，所搭配的行車記錄器也會因為電源的重新啟動而重開機一次。

更改設定為” Off” (停用)：

當您返回車上重新發動引擎，Power-PLUS會持續供電給行車記錄器，所搭配的行車記錄器則是維持開機狀態，不會重新開機。



建議設定：

建議啟用此功能，當每次返回車上重新發動引擎，行車記錄器主機也能由Smart Parking Mode狀態下重新開機，回覆至正常錄影狀態，同時執行重開機主機初始化動作，若有任何錯誤訊息發生，也可以透過螢幕與喇叭警示，減少當機可能，提高對於行車記錄器健康狀態的穩定度與關注程度。

引擎熄火後之LED螢幕顯示 (主開關切至Activate啟用)

模式開關切至 計時模式(Timer Mode)

引擎熄火之後，LED螢幕會先秀出BATT (電力來自汽車電瓶) 三秒鐘。



三秒之後，LED 螢幕會進入休眠，只有中央分號兩點會持續上下閃爍，如下圖示：

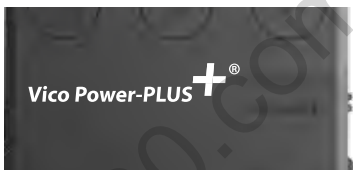

模式開關切至 正常模式(Normal Mode)

引擎熄火之後，LED螢幕會先秀出BATT (電力來自汽車電瓶) 三秒鐘。



三秒之後，LED 螢幕會進入休眠，只有右下角兩個小數點持續左右閃爍，如下圖示：



主開關(Activate/Bypass) 功能與切換說明

Bypass

當主開關切至” Bypass (停用)” 時，Power-PLUS模組停車供電功能停用，引擎熄火之後停止供電，引擎發動時則會正常供電。

當引擎發動時 (ACC ON), Power-PLUS 會正常供電給行車記錄器使用。當引擎熄火之後，Power-PLUS則會跟著關閉，停止供電給行車記錄器。

若您的停車時間超過七天以上，建議您將主開關切至” Bypass” 停用，或是將模式開關切至計時斷電模式使用。



Activate

當主開關切至” Activate(啟用)” 時，Power-PLUS模組功能啟用，會在引擎熄火之後持續供電。

當引擎發動時(ACC ON), Power-PLUS 會正常供電給行車記錄器使用。當引擎熄火時(ACC OFF, Power-PLUS會持續供電給行車記錄器使用 (此時電力從汽車電瓶提供)，Power-PLUS同時監控您的電瓶狀態，提供低電壓斷電保護，溫度過高斷電保護。若您的模式開關(Mode Switch)是切至Timer計時模式，引擎熄火之後會開始倒數計時斷電功能。

電力加-產品規格

輸入介面	Battery+ (B+) 黃色 ACC+ 紅色 GND 黑色 線長150公分
輸出介面	車充點煙母座插座 線長150公分
保險絲	位於B+線上之保險絲盒內 (250V/2A)
輸入電壓	12~24v (車用電瓶)
輸出電壓	12~24v
輸出電流	1A, 最大2A
待機電流 (Leakage Current)	100 μ A (0.1mA) 以下
自動斷電電壓設定 (input)	11.4v ~ 12.6v (+0.1V) 11.4 / 11.6 / 11.8 / 12.0 (預設) / 12.2 / 12.4 / 12.6 23.2v ~ 24.6v (+0.1V) 23.2 / 23.4 / 23.6 / 23.8 / 24 / 24.2 (預設) / 24.4 / 24.6
Voltage Offset Adjustment Setting	0.1/0.2/0.3/0.4/0.5/-0.1/-0.2/-0.3/-0.4/-0.5v
輸出回復電壓 (Restoration)	斷電電壓設定+ 0.2v 或以上
ACC Restore Reboot	Act. / Off
計時斷電設定	2 / 6 / 12 / 24 / 36 / 48 / 72 小時
溫度過高斷電設定 (攝氏 或 華氏)	Off /50° /55° /60° /65° /70° /75° C Off /122° /131° /140° /149° /158° /167° F
輸出回復溫度 (Restoration)	斷電溫度設定 -5° 或以下
工作溫度	-20°C ~ 75°C (-4° F ~ 167° F)
保護	低電壓斷電保護 溫度過高斷電保護 計時斷電保護 大電流與突波電流保護
操作按鍵與開關	主開關: Activate/Bypass 模式接換開關: Normal/Timer Mode 三類操作按鍵: 選單/選擇/確認鍵

售後服務支援

有任何安裝操作問題，歡迎來信或是致電視連科客服中心

台灣地區：

Line: Vicovation

Email: Service@vicovation.com



客服專線:02-2627-5883轉分機22, 23客服部

行動客服專線:0975-023-262

視連科客服中心地址:台北市內湖區瑞光路358巷38弄36號2樓之2

客服時間:週一~週五上午10:00~12:30，13:30~19:00 (例假日與國定假日除外)

歡迎您加入視連科Facebook專頁

www.facebook.com/VicoVation，可得到第一手產品

相關資訊與更新軟體資源，有任何問題也可以直接於Facebook留言提問。

中國地區：

視連科數碼科技(上海)有限公司

Wechat: Vicovation_china

Email: Service.cn@vicovation.com

客服專線:021-61197208

客服中心地址:上海市普陀區中山北路1715號707室(浦發廣場E座)

客服時間:週一~週五上午09:00~12:00，下午13:00~18:00(例假日與國定假日除外)

歡迎您關注視連科微博專頁

<http://weibo.com/3204503793>，可得到第一手

產品相關資訊與更新軟體資源，有任何問題也可以直接於微博留言提問。



免付費維修服務保固說明

1. 視連科產品主機提供一年保固，自消費者之原始購買日起算一年。用戶須出示原始購買日之證明 (發票或是保固卡) 始能享有保固服務。若無法提供正常購買證明，視連科將依產品序號判定保固期間。

2. 若產品主機在購買七日內 (含)，於正常操作下發生硬體故障，視連科提供免費更換新品。

如逾保固期之維修與配件更換則另行報價收費。

3. 台灣地區 (臺澎金馬) 保固期內，產品寄回視連科的運費，由使用者自行負擔。回送使用者的部分由視連科負責。保固期外與國外地區，兩趟運費皆由使用者自行負擔。

Serial No. :

序號 :

Date of Purchase:
Name (Stamp) of Seller:

Дата Продажи:
Продавец

經銷商蓋章處 :

本欄需蓋有經銷商店章及購買日期始得生效，缺一視同無效。

請妥善保管此產品保固卡或購買憑證。

若無法提供購買證明則以產品出廠日為保固生效日。

Date of Purchase: year month day



Copyright © 2015 VicoVation®

www.VicoVation.com

Autogoods “130”

130.com.ua