



PHONES

0 (800) 800 130
(050) 462 0 130
(063) 462 0 130
(067) 462 0 130

130
COM.UA

Internet store of
autogoods



SKYPE

km-130

CAR RECEIVERS — Receivers • Media receivers and stations • Native receivers • CD/DVD changers • FM-modulators/USB adapters • Flash memory • Facia plates and adapters • Antennas • Accessories |
CAR AUDIO — Car audio speakers • Amplifiers • Subwoofers • Processors • Crossovers • Headphones • Accessories | TRIP COMPUTERS — Universal computers • Model computers • Accessories |
GPS NAVIGATORS — Portable GPS • Built-in GPS • GPS modules • GPS trackers • Antennas for GPS navigators • Accessories | VIDEO — DVR • TV sets and monitors • Car TV tuners • Cameras • Videomodules • Transcoders • Car TV antennas • Accessories | SECURITY SYSTEMS — Car alarms • Bike alarms • Mechanical blockers • Immobilizers • Sensors • Accessories | OPTIC AND LIGHT — Xenon • Bixenon • Lamps • LED • Stroboscopes • Optic and Headlights • Washers • Light, rain sensors • Accessories | PARKTRONICS AND MIRRORS — Rear parktronic • Front parktronic • Combined parktronic • Rear-view mirrors • Accessories | HEATING AND COOLING — Seat heaters • Mirrors heaters • Screen-wipers heaters • Engine heaters • Auto-refrigerators • Air conditioning units • Accessories | TUNING — Vibro-isolation • Noise-isolation • Tint films • Accessories | ACCESSORIES — Radar-detectors • Handsfree, Bluetooth • Windowlifters • Compressors • Beeps, loudspeakers • Measuring instruments • Cleaners • Car seats • Miscellaneous | MOUNTING — Installation kits • Upholstery • Grilles • Tubes • Cable and wire • Tools • Miscellaneous | POWER — Batteries • Converters • Start-charging equipment • Capacitors • Accessories | MARINE AUDIO AND ELECTRONICS — Marine receivers • Marine audio speakers • Marine subwoofers • Marine amplifiers • Accessories | CAR CARE PRODUCTS — Additives • Washer fluid • Care accessories • Car polish • Flavors • Adhesives and sealants | LIQUID AND OIL — Motor oil • Transmission oil • Brake fluid • Antifreeze • Technical lubricant



In store "130" you can find and buy almost all necessary goods for your auto in Kyiv and other cities, delivery by ground and postal services. Our experienced consultants will provide you with exhaustive information and help you to choose the very particular thing. We are waiting for you at the address

<https://130.com.ua>



KICKER.



SS SERIES

LIVIN' LOUD

**OWNER'S MANUAL
SSM88, SSM86**

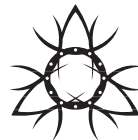

SS Series Midbass Drivers Owners Manual

Models: SSMB6 / SSMB8

Attention:

Please take a moment and record the information asked for below in the provided area. It is also a good idea to attach the original sales receipt or a copy of it to this page for future reference

If for any reason you require service on this Speaker during the warranty period, you will need to provide this information and a copy of the receipt to Kicker to validate your warranty.

ALWAYS KEEP YOUR RECEIPT!

Congratulations!

You have just purchased one of the latest in a long line of exceptional car audio products from Stillwater Designs. Your KICKER SS Series Midbass drivers were designed and engineered to deliver the ultimate in Midbass performance with unmatched durability.

*Thanks for buying KICKER.
Enjoy.*

Dealer Where Purchased: _____

Purchase Date: _____

Speaker Model Number: _____

Speaker Serial Number: _____

FEATURES

- **Ultra Slim Midbass Drivers**

Gives you real low frequency output from factory locations.

- **TRI-TECH™ CONE WITH RÖHM ROHACELL® FOAM**

Sandwiched cone material of foam, poly and woven carbon fiber. Provides a very light yet very strong cone for extended frequency response and superior cone control over the mid bass entire operating range. This new high-tech cone is found in our new SS component systems as well.

- **SANTOPRENE RUBBER SURROUND**

Tough, flexible surround with long throw, to control extreme cone excursions.

- **LPOD (LOW PROFILE/OPEN DESIGN) BASKET.**

This stamped steel basket provides a solid anti-resonant foundation for the motor assembly insuring that all the parts work together in harmony and prevent shifting or misalignment.

- **Spring Loaded Nickel Plated Terminals**

For solid connection with large gauge speaker wire.

- **Blackened Motor Structure and Kapton™ Voice Coil Formers**

For exceptional thermal power handling capability.

MOUNTING

Your KICKER drivers are specifically designed for mounting in free-air applications. While the speakers do not require a sealed enclosure for optimum performance, it is important to isolate the sound coming off the front of the driver from the sound radiating from the back of the driver. This isolation is usually accomplished by using the correct size driver in a factory speaker location.

Mounting

Caution must be observed when mounting speakers through the package tray of a car, watch for wiring harnesses, trunk springs, hinges, and folding seat mechanisms. When running the wires be careful not to damage them with seat bolts or door sill screws.

If custom door mounting locations are desired for your drivers, be careful to avoid interference from window and door lock mechanisms. The first step is to find a location on the door panel that will accept the size of speaker chosen. Then remove the door panel from the door, and check for the operation of the window all the way up and down. If metal must be cut to mount the speakers, try to avoid structural metal and braces. On models with grills included, mount as indicated in the following diagram. Figure 1.

For best sound performance a reinforcing panel should be added between the car's sheet metal and the door panel. See optional reinforcing panel as shown in the diagram labeled figure 1.

If factory door speaker wiring is not available to connect your speakers to, it is necessary to run the supplied wire through the door jamb. This wire should be kept away from sharp edges and the possibility of getting pinched.

An existing boot in the door jamb is the ideal place to run the wires, but sometimes this does not exist or is inaccessible.

Drilling holes to run wires through is very tricky, and caution must be exercised not to drill into other wiring or mechanisms.

Any time a wire is run through a bare hole, it is necessary to insert a rubber or plastic grommet first to protect the wire. Figure 2.

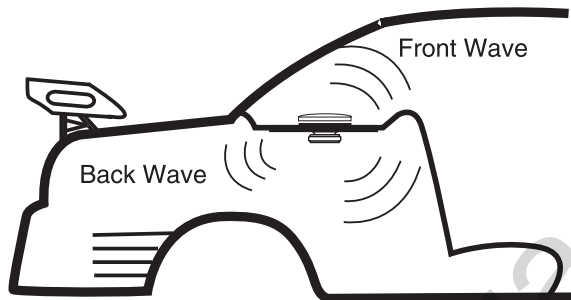

Figure 1

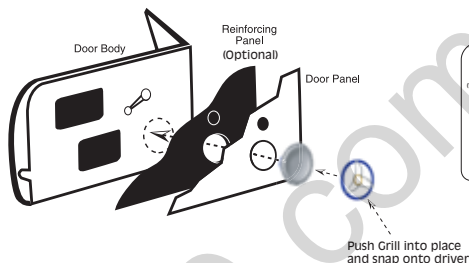
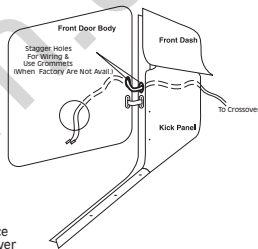

Figure 2



Wiring

Your Midbass driver has two spring loaded terminals. The red terminal is connected to the positive wire and the black terminal is connected to the negative wire from the source unit or amplifier. Since your midbass drivers have a limited frequency range it is recommended to use a bandpass crossover.

Use either a passive unit to connect into an existing system or for higher performance, an electronic crossover and a dedicated amplifier.

Kicker recommends using the SSMB series midbass drivers in conjunction with the SS Series or Kicker Series Components. This will create a seamless sound stage.

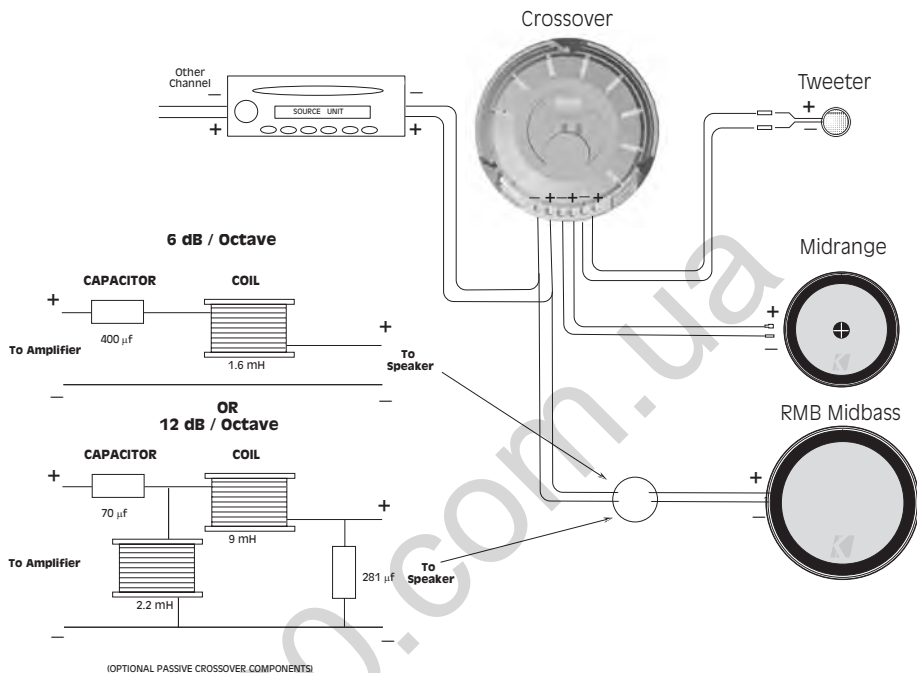

If you have more questions about the installation of your KICKER component, see the Authorized KICKER Dealer where you made your purchase. You may contact us via the Technical Services page on www.kicker.com. or call our Technical Services Line at (405)624-8583

Performance

MODEL	Frequency Response	Power Peak / RMS	Cut Out (in. / cm)	Mounting Depth (in. / cm)	Sensitivity (1 W / 1 M)
SSMB 6	30-500	250 / 125	5 5/8 / 14.29	2 / 5.08	88
SSMB 8	30-500	350 / 175	7 1/4 / 18.42	2 1/4 / 5.8	89
Available in 4 ohm models only.					

ACOUSTICS LIMITED WARRANTY

Kicker warrants this product to be free from defects in material and workmanship under normal use for a period of **THREE (3) MONTHS** from date of original purchase with receipt. When purchased from a Authorized KICKER Dealer it is warranted for **ONE (1) YEAR** from date of original purchase with receipt. In all cases you **must have the original receipt!** Should service be necessary under this warranty for any reason due to manufacturing defect or malfunction during the warranty period, Kicker will repair or replace (at its discretion) the defective merchandise with equivalent merchandise at no charge. Warranty replacements may have cosmetic scratches and blemishes. Discontinued products may be replaced with more current equivalent products.

This warranty is valid only for the **original purchaser** and is not extended to owners of the product subsequent to the original purchaser. Any applicable implied warranties are limited in duration to a period of the express warranty as provided herein beginning with the date of the original purchase at retail, and no warranties, whether express or implied, shall apply to this product thereafter. Some states do not allow limitations on implied warranties, therefore these exclusions may not apply to you.

This warranty gives you specific legal rights; however you may have other rights that vary from state to state.

WHAT TO DO IF YOU NEED WARRANTY OR SERVICE

Defective merchandise should be returned to your local Authorized Stillwater Designs (Kicker) Dealer for warranty. Assistance in locating an Authorized Dealer can be obtained by writing or calling Stillwater Designs direct. You can confirm that a dealer is authorized by asking to see a current authorized dealer window decal.

If it becomes necessary for you to return defective merchandise directly to Stillwater Designs (Kicker), call the Kicker Customer Service Department at (405)624-8510 for a Return Authorization (RMA) number. Package all defective items in the original container or in a package that will prevent shipping damage, and return to

Stillwater Designs, 5021 North Perkins Road, Stillwater, OK 74075

The RMA number must be clearly marked on the outside of the package. Return only defective components. Return of entire cabinets, system packs, pairs, etc. increases your return freight charges. Non-defective items received will be returned freight collect.

Include a dated **proof-of-purchase** stating the Customer name, Dealer name, product purchased and date of purchase.

Warranty expiration on items without proof-of-purchase will be determined from type of sale and the manufacturing date code.

Freight must be prepaid; items received freight collect will be refused.

Failure to follow these steps may void your warranty. Any questions can be directed to the Kicker Customer Service Department at (405)624-8510.

WHAT IS NOT COVERED?

This warranty is valid only if the product is used for the purpose for which it was designed. It does not cover:

- ĩ Damage due to improper installation.
- ĩ Subsequent damage to other components.
- ĩ Damage caused by exposure to moisture, excessive heat, chemical cleaners, and/or UV radiation.
- ĩ Damage through negligence, misuse, accident or abuse. Repeated returns for the same damage may be considered abuse.
- ĩ Any cost or expense related to the removal or reinstallation of product.
- ĩ Speakers damaged due to amplifier clipping or distortion.
- ĩ Items previously repaired or modified by any unauthorized repair facility.
- ĩ Return shipping on non-defective items.
- ĩ Products with tampered or missing barcode labels.
- ĩ Products returned without a Return Authorization (RMA) number.
- ĩ Freight Damage.
- ĩ The cost of shipping product to Kicker.
- ĩ Service performed by anyone other than Kicker.
- ĩ Speaker with any foreign caulk used for gasket material.

HOW LONG WILL IT TAKE?

Kicker strives to maintain a goal of 24-hour service for all acoustics (woofers, mids, tweets, etc.) returns. Delays may be incurred if lack of replacement inventory or parts is encountered.

INTERNATIONAL WARRANTY

Contact your International Kicker dealer or distributor concerning specific procedures for your country's warranty policies.



STILLWATER
Designs®

P.O. Box 459 | Stillwater, Oklahoma 74076 | U.S.A.
ĩ 405 624-8510

WARNING:

KICKER drivers are capable of producing sound levels that can permanently damage your hearing! Turning up a system to a level that has audible distortion is more damaging to your ears than listening to an undistorted system at the same volume level. The threshold of pain is always an indicator that the sound level is too loud and may permanently damage your hearing. Please use common sense when controlling volume!

130.com.ua

130.com.ua

130.com.ua

130.com.ua

