



PHONES

0 (800) 800 130
(050) 462 0 130
(063) 462 0 130
(067) 462 0 130

130
COM.UA

Internet store of
autogoods



SKYPE

km-130

CAR RECEIVERS — Receivers • Media receivers and stations • Native receivers • CD/DVD changers • FM-modulators/USB adapters • Flash memory • Facia plates and adapters • Antennas • Accessories |
 CAR AUDIO — Car audio speakers • Amplifiers • Subwoofers • Processors • Crossovers • Headphones • Accessories | TRIP COMPUTERS — Universal computers • Model computers • Accessories |
 GPS NAVIGATORS — Portable GPS • Built-in GPS • GPS modules • GPS trackers • Antennas for GPS navigators • Accessories | VIDEO — DVR • TV sets and monitors • Car TV tuners • Cameras • Videomodules
 • Transcoders • Car TV antennas • Accessories | SECURITY SYSTEMS — Car alarms • Bike alarms • Mechanical blockers • Immobilizers • Sensors • Accessories | OPTIC AND LIGHT — Xenon • Bixenon • Lamps
 • LED • Stroboscopes • Optic and Headlights • Washers • Light, rain sensors • Accessories | PARKTRONICS AND MIRRORS — Rear parktronic • Front parktronic • Combined parktronic • Rear-view mirrors
 • Accessories | HEATING AND COOLING — Seat heaters • Mirrors heaters • Screen-wipers heaters • Engine heaters • Auto-refrigerators • Air conditioning units • Accessories | TUNING — Vibro-isolation
 • Noise-isolation • Tint films • Accessories | ACCESSORIES — Radar-detectors • Handsfree, Bluetooth • Windowlifters • Compressors • Beeps, loudspeakers • Measuring instruments • Cleaners • Car seats
 • Miscellaneous | MOUNTING — Installation kits • Upholstery • Grilles • Tubes • Cable and wire • Tools • Miscellaneous | POWER — Batteries • Converters • Start-charging equipment • Capacitors
 • Accessories | MARINE AUDIO AND ELECTRONICS — Marine receivers • Marine audio speakers • Marine subwoofers • Marine amplifiers • Accessories | CAR CARE PRODUCTS — Additives • Washer fluid •
 Care accessories • Car polish • Flavors • Adhesives and sealants | LIQUID AND OIL — Motor oil • Transmission oil • Brake fluid • Antifreeze • Technical lubricant



In store "130" you can find and buy almost all necessary goods for your auto in Kyiv and other cities, delivery by ground and postal services. Our experienced consultants will provide you with exhaustive information and help you to chose the very particular thing. We are waiting for you at the address

<https://130.com.ua>

Maxi-Cosi Pearl



Dear Parents,
To ensure maximum protection and optimum comfort for your child, it is important that you read through the entire manual accompanying the product carefully and follow all instructions. The information provided here can also be helpful if you no longer have the original manual or require additional information on your Maxi-Cosi Pearl.

Legend

- A Cover (fabric)
- B Adjustable headrest.
- C Shoulder and lap belts with removable belt pads
- D Belt buckle
- E Crotch strap with belt pad
- F Belt tensioner strap
- G Mounting bars for Maxi-Cosi FamilyFix
- H Flexible plastic rim

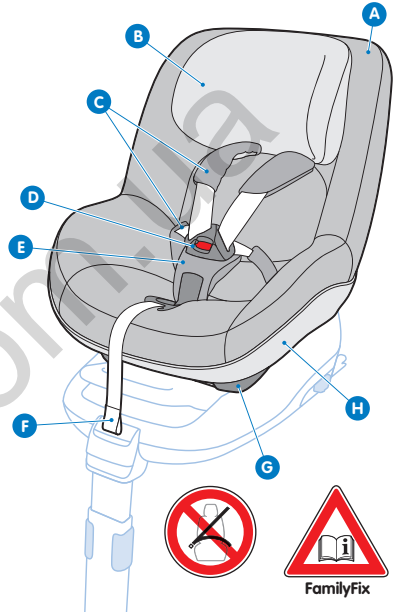

Contents

1. Safety

- 1.1 General Maxi-Cosi Pearl information
- 1.2 Maxi-Cosi Pearl maintenance instructions
- 1.3 Maxi-Cosi Pearl and your child
- 1.4 Maxi-Cosi Pearl car use

2. Installing and removing the Maxi-Cosi Pearl

- 2.1 Maxi-Cosi FamilyFix
- 2.2 Installing the Maxi-Cosi Pearl
- 2.3 Removing the Maxi-Cosi Pearl

3. Maxi-Cosi Pearl and your child

- 3.1 Adjusting the height of the harness system
- 3.2 Placing your child in the Maxi-Cosi Pearl
- 3.3 Seat positions (Adjusting into sitting and reclining position)
- 3.4 Adjusting the headrest

4. Maintenance

- 4.1 Cleaning the plastic parts
- 4.2 Removing the cover
- 4.3 Cleaning the cover
- 4.4 Reattaching the cover
- 4.5 Belt buckle and belt adjustment system functioning and cleaning

5. Next stage car seats

6. Waste separation

7. Questions

1. Safety

Warning: The Maxi-Cosi Pearl can **ONLY** be used on a Maxi-Cosi FamilyFix base with IsoFix.

1.1 General Maxi-Cosi Pearl information

- Read this instruction manual and that of the Maxi-Cosi FamilyFix carefully and keep it for future reference.
- You are personally responsible for the safety of your child at all times.
- Never hold your child on your lap when driving.
- The Maxi-Cosi Pearl is intended for car use only.
- Do not use the Maxi-Cosi Pearl if the seat is more than 5 years old.
- Do not use second-hand products whose history is unknown.
- Replace the Maxi-Cosi Pearl after an accident.
- The Maxi-Cosi Pearl meets all legal requirements of the **ECE R 44/04**, the latest European standard for car safety seats, and may only be used in combination with the Maxi-Cosi FamilyFix.
- The Maxi-Cosi Pearl is suitable for children weighing between 9 and 18 kg (ECE R44/04 Group 1: 9 -18 kg).
- Read this instruction manual carefully.

Warning: Do not make any changes to the Maxi-Cosi Pearl whatsoever, as this could lead to unsafe situations.

1.2 Maxi-Cosi Pearl maintenance instructions

- Use the original cover only, since it is part of the safety features of this product.
- The Maxi-Cosi Pearl must undergo regular maintenance.
- Do not use any lubricants or aggressive cleaning agents on this product.

1.3 Maxi-Cosi Pearl and your child

- Never leave your child unattended.
- Always secure your child with the harness belt.
- Check to make sure the headrest is adjusted to the proper height.
- Before every use, make sure the harnesses are not damaged or twisted.
- Make sure you can fit no more than one finger between the belts and your child (1cm).

1.4 Maxi-Cosi Pearl car use

- Always check to make sure the car seat can be installed properly in your car before purchasing it.
- Make sure the fold-down rear seat is locked into position.
- Prevent the Maxi-Cosi Pearl from becoming trapped or weighed down by luggage, seats and/or slamming doors.
- Make sure all luggage and other loose objects are secured.
- Deactivate the airbag if using the Maxi-Cosi Pearl on the front passenger seat. If this is not possible, place the passenger seat in the rearmost position.
- Always cover the Maxi-Cosi Pearl when exposed to direct sunlight in the car. Otherwise, the cover, metal and plastic parts could become too hot for your child's skin.

Warning: The Maxi-Cosi Pearl must always be placed in a forward-facing position in the car on a Maxi-Cosi FamilyFix.

2. Installing and removing the Maxi-Cosi Pearl

The Maxi-Cosi Pearl may only be used together with the Maxi-Cosi FamilyFix base. The Maxi-Cosi Pearl and Maxi-Cosi FamilyFix can only be safely installed on forward-facing seats fitted with IsoFix anchor points. Remove the headrest of the seat where the Maxi-Cosi Pearl is to be installed if it is in the way. Do not forget to put the headrest back when the seat is to be used again. The Maxi-Cosi FamilyFix 'click-and-go' installation method reduces the chance of incorrect installation in the car and ensures optimum user-friendliness. The Maxi-Cosi FamilyFix must be installed in the car first.

Important!

- Before installing or removing the Maxi-Cosi FamilyFix, read through the instructions. The safety of your child can only be guaranteed with proper use. It is therefore important that you take the time to read through these instructions carefully. However, if you do not have these instructions, contact our service point in your country or download the necessary information from our website at www.maxi-cosi.com.
- The Maxi-Cosi FamilyFix is not suitable for use in all types of cars and therefore has been approved for 'semi-universal' use, which means it is designed for installation on the seats of specific car makes. Check to make sure your car is listed in the approved list of car makes ('car fitting list') at www.maxi-cosi.com.

2.1 Maxi-Cosi FamilyFix

- The Maxi-Cosi FamilyFix may only be used on a forward-facing seat equipped with IsoFix anchor points. Read the car manufacturer's handbook before use.
- Correct attachment to the IsoFix anchor points is essential for the safety of your child. Also see the yellow outlined sticker at the top of the Maxi-Cosi FamilyFix.
- The LED indicators on the display indicate whether the product has been installed correctly: the attachment of the IsoFix connectors to the IsoFix anchor points, stable positioning of the support leg, and the attachment of the Maxi-Cosi Pearl on the Maxi-Cosi FamilyFix.
- Check proper installation by pressing the 'test' button. If one of the LED indicators is red, do NOT start driving.

2.2 Installing the Maxi-Cosi Pearl

1. Position the Maxi-Cosi Pearl on the Maxi-Cosi FamilyFix **in a forward-facing position** (i.e. facing the windscreen).
2. Click the two attachment spindles (G) on the Maxi-Cosi Pearl securely onto the anchor points on the Maxi-Cosi FamilyFix.
3. Check that the Maxi-Cosi Pearl has been installed correctly by pulling on it.

Important!

- You should hear a clearly audible 'click' and all three LED indicators should be green.
- Under no circumstances should this product be used if any of the indicators remain red. In that case, repeat the above actions. In case of doubt or if you have any questions, contact the supplier.
- Never try to use a different installation method than the one described here!

2.3 Removing the Maxi-Cosi Pearl

1. Remove the Maxi-Cosi Pearl by pulling the release lever on the Maxi-Cosi FamilyFix upwards while tilting the car seat forward. This releases the two attachment spindles (G) from the anchor points.
2. Remove the Maxi-Cosi Pearl from the Maxi-Cosi FamilyFix.

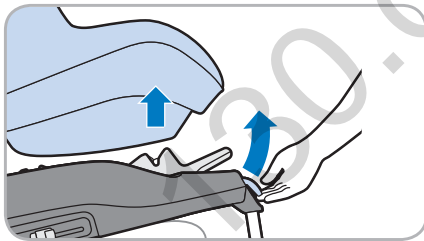
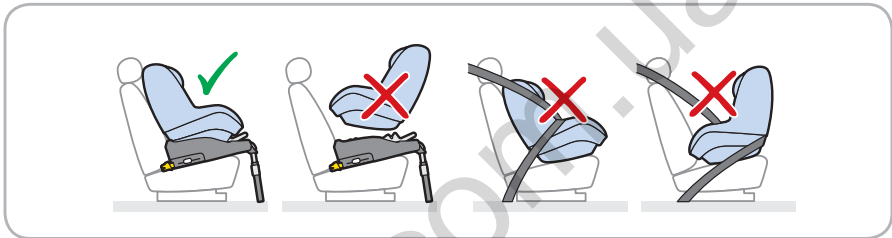
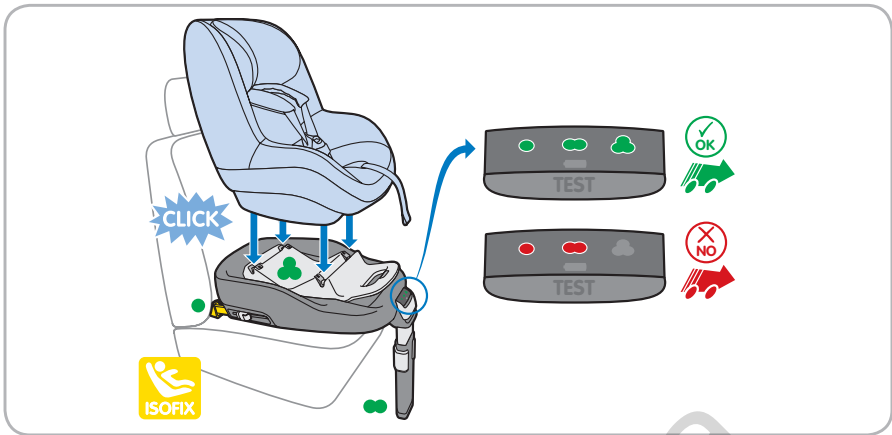

3. Maxi-Cosi Pearl and your child

3.1 Adjusting the height of the harness and headrest

Before placing your child in the Maxi-Cosi Pearl and locking the harness system, you must first determine the correct height of the shoulder belts and headrest. The height of the shoulder belts (C) is correct if the belts disappear into the shell slightly above the child's shoulders. The headrest will automatically slide upwards/downwards.

1. Open the belt buckle (D) by pressing the red button on the belt buckle.
 - Loosen the shoulder belts (C) by pushing the belt buckle forward.
2. Pull the shoulder belts (C) as far forward as possible. Do not pull on the belt pads when doing this.
3. Place the child with his or her back straight upright in the Maxi-Cosi Pearl and check the belt height.
 - The height of the shoulder belts (C) is correct if the belts disappear into the shell slightly above the child's shoulders.
4. If necessary, adjust the shoulder belts (C) to the proper height.
 - To adjust the shoulder belts (C) and headrest (B) to the proper height, move the headrest upwards or downwards. Lightly squeeze the headrest handle (grey area at the back) and move it upwards or downwards.

Important!

- The headrest can only be adjusted in height when the belt buckle is open.

3.2 Placing your child in the Maxi-Cosi Pearl

1. Place your child with his or her back straight upright in the Maxi-Cosi Pearl and close the belt buckle (D) by placing together the two buckle sections and inserting them into the buckle. You should hear a clearly audible 'click'.
2. Pull on the shoulder belts above the buckle (C) to remove any slack in the lap belts.
3. Now pull the harness system (F) tight by pulling on the adjustment strap.
4. You should be able to fit no more than one finger (1 cm) between your child and the shoulder belt.
 - Repeat steps 2, 3 and 4 if the space between your child and the shoulder belt (C) is bigger.

Important!

- Make sure there are no toys or other hard objects in the shell.
- Make sure the belts are not twisted.
- The height of the shoulder belts is correct if the belts disappear into the shell slightly above the child's shoulders.
- The tighter the belts fit around your child, the better the protection.
- Always use the belt pads, as they are essential to your child's safety.
- Tell the child to never play with the belt buckle.
- Once the belt buckle is locked, the belt system becomes blocked and it is only possible to tighten the belts. If you need to make the belts longer, you must first open the belt buckle.

3.3 Seat positions (Adjusting into sitting and reclining position)

The Maxi-Cosi Pearl can be adjusted into several sitting and sleeping positions by pushing the button on the handle of the Maxi-Cosi FamilyFix while at the same time moving the seat towards you or away from you. Release the handle in the desired position and push until you hear a click.

130.com.ua

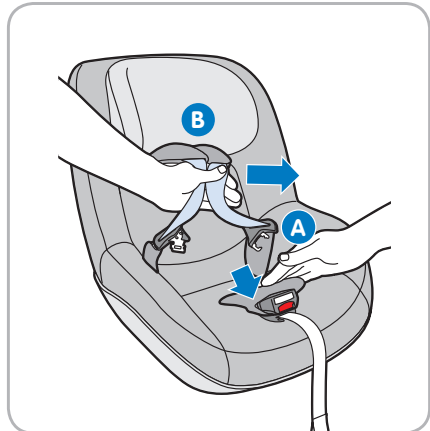
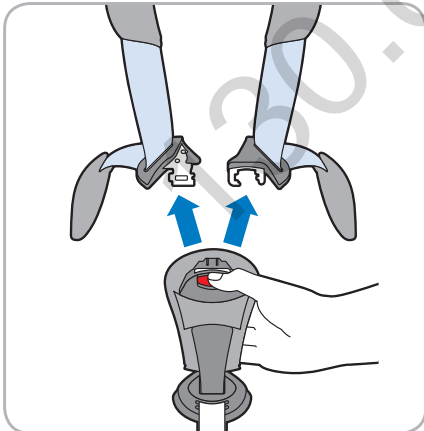
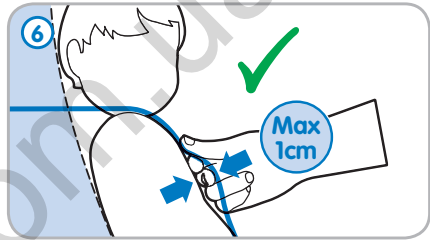
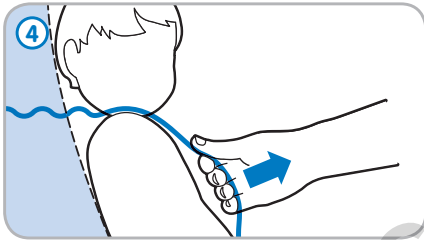
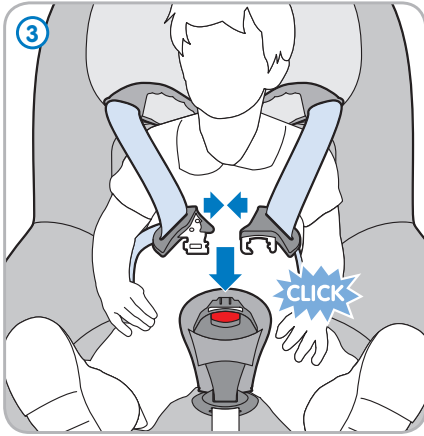

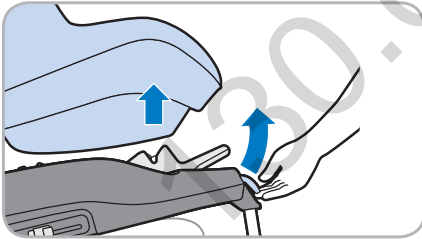
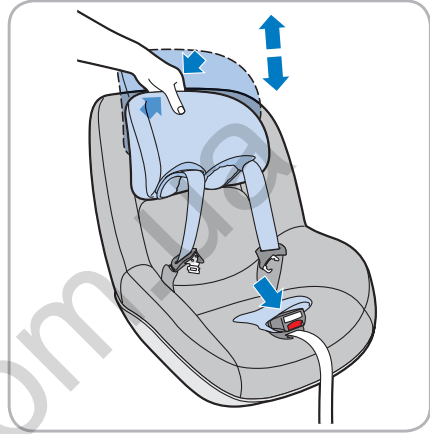
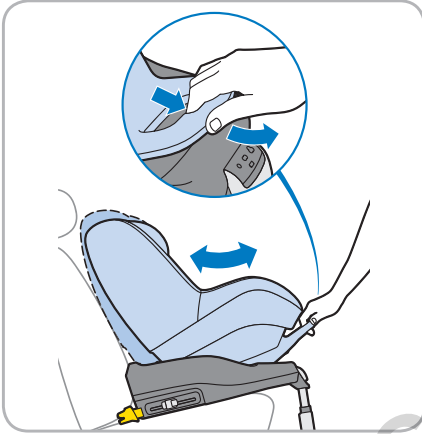
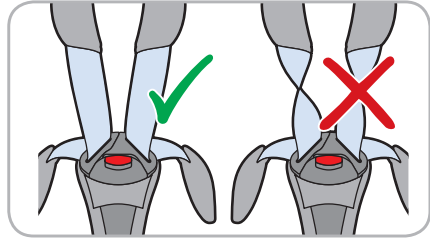

4. Maintenance

4.1 Cleaning the plastic parts

- Clean the car seat and flexible plastic plastic rim (H) using lukewarm water, soap and a soft cloth.
- Do not use any lubricants or aggressive cleaning agents.
- The belt buckle (D) can be rinsed clean with hot water.

4.2 Removing the cover

1. Open the belt buckle (D). Loosen the shoulder belts (C) by pulling them forward as far as possible.
2. Pull the cover (A) out from under the flexible plastic plastic rim (H).
3. Loosen the cover (A) under the belt buckle (D).
4. Pull the belt buckle (D) through the belt buckle pad and cover.
5. Loosen the press fasteners and Velcro of the back flap from the cover and fold it forwards.
6. Now carefully pull the cover at the back of the seat (A) upwards and over the headrest.
7. Remove the car seat cover (A).

Removing the shoulder belt pads

1. Open the belt pads of the shoulder belts (C) by loosening the press fasteners and the Velcro.
2. Remove the belt from the belt pad.
3. Slide the clasp out of the belt pad loop.
4. Remove the belt pad from the spring.
5. Do this with both belt pads.

Removing the lap belt pads

1. Open the belt pads of the lap belt by loosening the press fasteners and the Velcro.
2. Remove the belt pad from the spring.
3. Do this with both belt pads.

Removing the headrest cover

1. Remove the headrest cover by removing the two elastic bands from the bottom flap under the plastic part.
2. Loosen the headrest cover on one side under a point and remove the cover carefully on this side of the headrest.
3. Then loosen the cover on the other side in the same way.
4. Finally, carefully remove the headrest cover.

4.3 Cleaning the cover

Wash the cover (A) and belt pads in lukewarm water (maximum of 30°C). Do not place them in the dryer or use the spin cycle. Also see the care instructions on the cover.

4.4 Reattaching the cover

1. Repeat the above steps in the reverse order!
 - First attach the 4 belt pads and the headrest cover before reattaching the cover (A).
2. Check to make sure the cover (A) fits tightly all around and is attached properly.

Important!

- Never remove the energy-absorbing foam.
- All maintenance to the Maxi-Cosi Pearl should take place when the car seat is outside the car.
- The Maxi-Cosi Pearl may only be used with the cover. The cover may not be replaced by a cover other than the one supplied by the manufacturer, as the cover is part of the seat's safety.

Tip: It is advisable to buy an extra cover when purchasing the Maxi-Cosi Pearl so that you can continue to use it even when the cover is being washed and dried.

4.5 Belt buckle and belt adjustment system functioning and cleaning

The proper functioning of the belt buckle and belt adjustment system is very important for the safety of your child. The most common reason that the buckle does not function properly is because it is dirty (from dust, grime, food particles, etc.). So make sure to keep the belt buckle and belt adjustment system clean (using a vacuum cleaner if necessary).

If the belt adjustment system is not functioning properly, contact your supplier or importer immediately. Under no circumstances should the Maxi-Cosi Pearl be used!

The following is a list of possible causes of function failure and possible solutions.

A. Belt buckle malfunctioning

- When opening the belt buckle, the buckle sections release slowly.
- The belt buckle can only be opened using considerable force.
- It is difficult to click the buckle sections into the buckle (too much resistance).
- The buckle will no longer close or the buckle sections do not fit together.
- There is no audible 'click' when closing the buckle.

B. Resolving buckle problems

- Check the buckle for any dirt and, if necessary, clean it by knocking out the dirt, rinsing it, blasting it with air or vacuuming it.

Important!





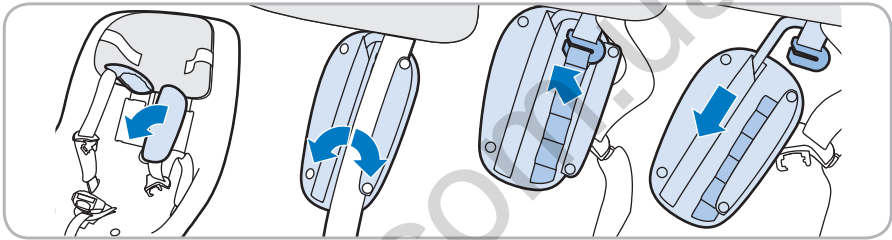
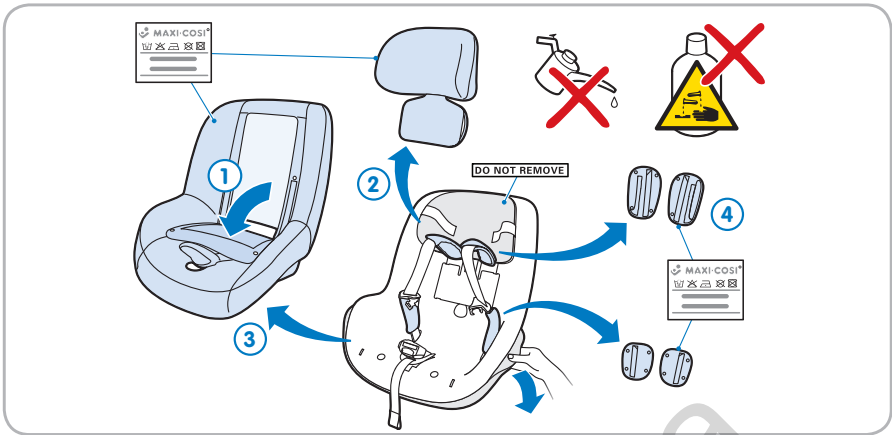



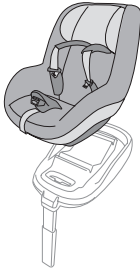

- **Never** use lubricants!

If you are unable to close the belt buckle or if you are unsure whether you have solved the problem correctly, contact your supplier or importer immediately. Under no circumstances should the Maxi-Cosi Pearl be used!



5. Next stage car seats

Maxi-Cosi Car seats

Maxi-Cosi Pebble	Maxi-Cosi Pearl	Maxi-Cosi Tobi	Maxi-Cosi Axiss	Maxi-Cosi Rodi XR
				
0-13 kg	9-18 kg	9-18 kg	9-18 kg	15-36 kg
FamilyFix EasyBase 2	FamilyFix			
  				

6. Waste separation

To ensure optimum and safe use of car safety seats, they should not be used for longer than 5 years after the date of purchase. Ageing of the plastic, for instance under the influence of sunlight (UV), may quite unnoticeably reduce the qualities of the product.

Once the child has grown out of the seat, we therefore recommend that you no longer use the car seat and dispose of it properly.

Out of concern for the environment, we ask that users of the Maxi-Cosi Pearl separate the waste generated by the Maxi-Cosi FamilyFix from the start (packaging) to the moment of discarding (product parts), and dispose of it in accordance with local legislation.

Important!

Keep plastic packaging away from children to avoid the danger of suffocation.

7. Questions

If you have any questions, contact your local Maxi-Cosi retailer (see www.maxi-cosi.com for contact information). Make sure you have the following information on hand:

- Serial number on the orange ECE sticker on the bottom of the Maxi-Cosi Pearl;
- Make and type of car and seat on which the Maxi-Cosi Pearl is used
- Age (length) and weight of your child.

130.com.ua