

Please, read this manual  
carefully before use!

Owner's Manual



## Jump starter with air compressor

KS JSP-1200

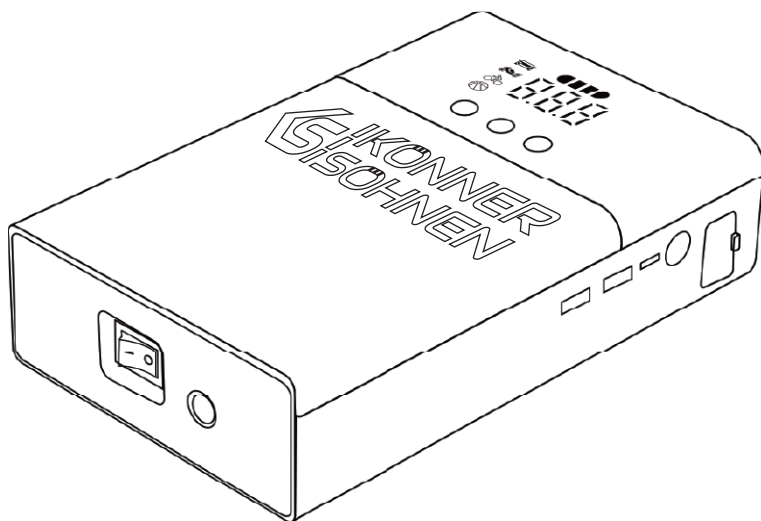



Thank you for your purchase of **Könnér & Söhnen®** products. This manual contains a brief description of safety, use and debugging. More information can be found on the official manufacturer's website in the support section: [konner-sohnen.com/manuals](http://konner-sohnen.com/manuals)

You can also go to the support section and download the manual by scanning the QR code, or on the website of the official importer of Könnér & Söhnen® products: [www.konner-sohnen.com](http://www.konner-sohnen.com) (for Europe), [uk.koenner-soehnen.com](http://uk.koenner-soehnen.com) (for the UK), [www.konner-sohnen.com/en-us](http://www.konner-sohnen.com/en-us) (for the USA).



(for Europe)



(for UK)



(for USA)

*Please, read this manual carefully before use!*

Manufacturer reserves the right to make alterations into the generators, which may not be reflected in this manual. Pictures and photos of the product may vary from its actual appearance. At the end of this manual, You may find contact information which you are free to use in case of any issues occurrence.

All data, specified in this operation manual is the most up to date for the moment of its publishing. The current list of service centers you can find at the website of official importer: [www.konner-sohnen.com](http://www.konner-sohnen.com) (for Europe), [www.konner-sohnen.com/en-us](http://www.konner-sohnen.com/en-us) (for the USA).



**ATTENTION – DANGER!**



**Failure to follow the recommendations marked with this sign may lead to serious injury of the operator or third parties.**



**IMPORTANT!**



**Useful information while operating the machine.**

## JUMP STARTER WITH AIR COMPRESSOR

1

Jump starter has following functions



Jump starter



Device charging function



Cordless air compressor



Flashlight function

**Jump starter KS JSP-1200 can instantly start 12V vehicles up to 8.0-Liter petrol or 4.0-Liter diesel engines. To avoid safety risks, please do not jump start the car with an unsuitable low capacity.**

1. Air hose connector
2. Air compressor switch
3. Pressure down
4. Mode selection
5. Pressure up
6. Intelligent digital display
7. DC connector/Output for connecting the terminals of the jump starter
8. Power switch
9. Charging port
10. USB outputs

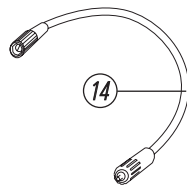
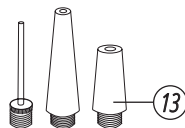
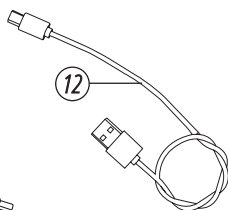
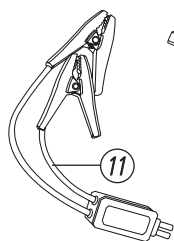
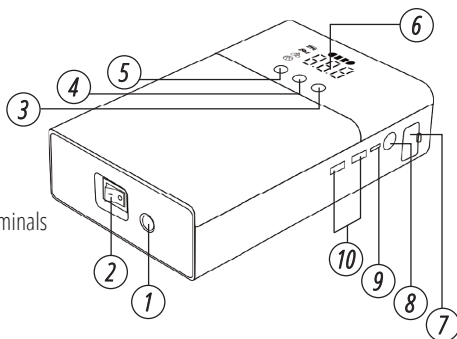

### THE PACKAGE INCLUDES:

- Jump starter
- Packaging
- Operating instruction
- 11. Smart clamp
- 12. USB charging cable
- 13. Nozzle adapters+Accessories storage bag
- 14. Air hose



**IMPORTANT!**



Manufacturer reserves the right to make changes and/or improvements in design, components set and technical attributes without notice and without incurring obligation. The pictures in this manual are schematic and may not match the parameters of original product.

## TECHNICAL SPECIFICATION

Model KS JSP-1200 parameters	Value
Battery	14000 mAh
Max. pneumatic pressure	150 psi
USB output	2x5V/2A
USB input	5V/2A
Rated starting current	600 A
Peak current	1200 A
Charging time	4-5 hours
Net dimensions (LxWxH)	200x130x52 mm
Net weight	1.45 kg
Operating temperature	(-20 °C) – (+60 °C)

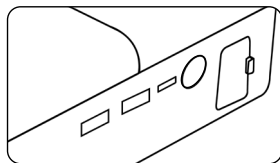

### HOW TO USE LED EMERGENCY LIGHTING

Press and hold the key for 3 seconds to turn on the flashlight, then the light button function changes from solid light to flashing, SOS distress signal light. Press and hold again for three seconds to turn off the flashlight.

### HOW TO START A CAR WITH A FLAT BATTERY:



**WARNING!**



**The device is suitable only for 12V batteries!**

When starting the car, please confirm that the power of the product is more than 20%.

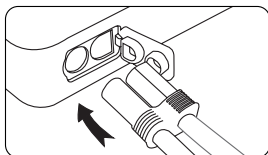

**STEP 1:** Open the silicone stopper of the product and insert the battery clamp into the corresponding hole of the product.

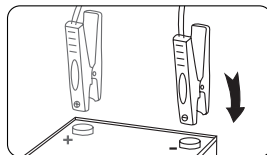

**STEP 2:** Connect the battery clamp to the positive and negative poles of the car battery (Red for the positive terminal and black for the negative terminal).

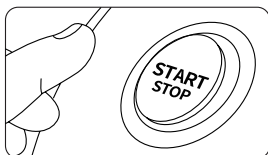

**STEP 3:** Start the engine. Do not cycle the jump starter for more than 3 seconds, pause for 1 minute between jump start attempts. This is necessary to let the jump starter battery cool down.

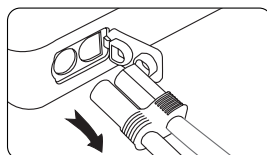

**STEP 4:** The plug is withdrawn from the jump starter first, and then the battery clips are removed from the positive and negative terminals.

When the connection is successful, the indicator lights up green.

The red light indicates that the supply voltage is too low or that the positive and negative electrode terminals have been swapped.

### DEVICE CHARGING FUNCTION:

Plug the USB charging cable into the product 5V/2A USB interface. Plug the other end of the charging cable into the corresponding interface of the mobile phone or digital product. After connecting the cable, press the SWITCH key (device switch) to start power supply.

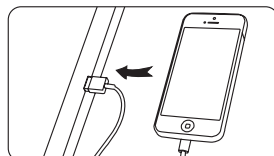
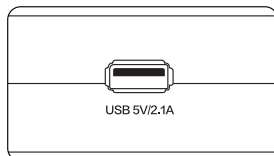

The device is protected against overheating. If the device gets overheated, the red indicator light will be on continuously, and the buzzer will emit 2 beeps per second. Once the fault has been rectified, the buzzer will return to normal status. Overtemperature protection is triggered at 80 °C.

The device features protection against overcurrent. If the protection is triggered, the device will automatically shut down, the protection indicator will light up, and the buzzer will emit 4 beeps per second. After the fault has been rectified, the indicator will immediately return to normal status.

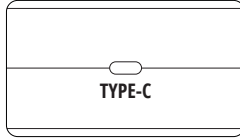

It is recommended that you use an AC adapter with an output of at least 5V/1A or preferably 5V/2A for charging. It can be a smartphone or tablet charger.

Insert the matching adapter and charger plug into the USB Type-C input port of the product.

### AIR COMPRESSOR FUNCTION

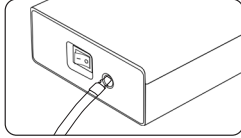

Connect one end of the inflation line to the air hole

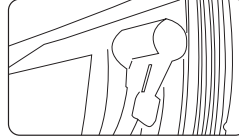

Connect one end of the inflation cable to the tire

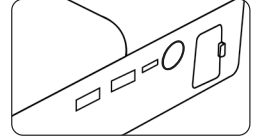

After connecting the wires, press the key to start the machine

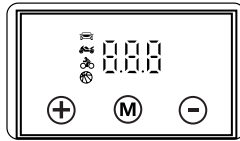

Then press the M key to select the mode (cars, motorcycles, bicycles, sports equipment).

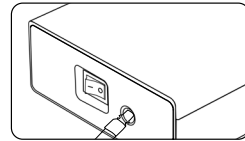

Turn on the inflation switch to inflate and automatically stops when the desired parameters are reached

### WARNING

5

1. Read the operating instructions carefully before using the device.
2. The device must never be used as a substitute for a car battery.
3. Keep children and animals away from the working area of the device.
4. Only use the jump starter for 12 V batteries.
5. Keep the clips and their connection points clean and tidy. Never connect the clips together.
6. Avoid using the device near explosive substances, flammable gases, or in dusty environments.
7. Avoid overheating the device, smoking near the device, and exposing the device to extreme moisture; keep the device away from open flames and never immerse it in water.
8. The device must not be stored at temperatures exceeding 60 °C.
9. After successfully jump-starting the vehicle, disconnect the jump starter from the battery within 30 seconds to prevent equipment damage.
10. Do not use the jump starter cable to charge other devices.
11. Keep it supervised while charging.
12. Using the device at current and voltage ranges other than those specified on the device nameplate may cause charging and discharging problems and deterioration of battery capacity and performance. This is also dangerous and may cause the device to malfunction.
13. When the battery is stored for more than three months, the product needs to be charged to ensure the normal performance of the product.

14. Never do anything that may cause mechanical damage to the device.
15. Do not disassemble or transform the product without authorization.
16. If the device casing is bulged, leaking, or giving off an unpleasant odor, stop using the device immediately.
17. If you notice battery acid leaking from the battery, do not touch it with bare hands. If battery acid contacts the skin or eyes, rinse immediately with plenty of running cold water and soap. Flush eyes for at least 10 minutes. Seek medical advice if necessary.
18. The device features a lithium rechargeable battery that must be disposed of under the applicable laws in your country.
19. Please connect the starting cable correctly according to the manual.
20. Never attempt to jump-start the vehicle in continuous mode! With standard power, the start cycle should take no more than 3 seconds, and the interval between cycles should be at least 1 minute. Do not exceed 3 consecutive start attempts.
21. After starting the car with the starting power, the temperature of the starting power supply itself will rise, please do not charge the starting power at this time, at least 8-10 minutes before charging.
22. Only use the jump starter cable supplied with the jump starter.
23. Do not charge the device immediately after jump-starting the vehicle's battery.
24. Never use the device to start the vehicle's battery and charge the device's internal battery simultaneously.



# EC Declaration of Conformity

Nr. 158

The following products have been tested by us with the listed standards and found in compliance with the European Community Electromagnetic compatibility Directive (EMC) 2014/30/EC.

Manufacturer: DIMAX INTERNATIONAL GmbH  
Address: Flinger Broich 203, 40235 Duesseldorf, Germany  
Product: Jump starter with air compressor "Könner & Söhnen"  
Type / Model: KS JSP-1200

The statement is based on a single evaluation of above mentioned products. It does not imply an assessment of the whole production and does not permit the use of the test lab. logo. The manufacturer should ensure that all product in series production are in conformity with the product sample detailed in this report. The applicant should hold the whole technical report at disposal of the competent all the right.

Applied EC Directives: 2014/30/EU Electromagnetic compatibility Directive (EMC)  
EU RoHS 11/65/EU  
2015/863/EU

Applied Standard: EN IEC 61000-6-3:2021  
EN IEC 61000-6-1:2019  
EN IEC 61000-3-2:2019+ A1:2021  
EN 61000-3-3:2013+A1:2019



23

**Issued Date:** 2023-08-10  
**Place of issue:** Duesseldorf  
**General director:** Fomin P.

*P. Fomin*

**DIMAX  
International  
GmbH**  
Steuer-Nr: 103 5722 2493  
USt-Id-Nr: DE296177274

We DIMAX INTERNATIONAL GmbH hereby declare that specified above conforms covering European Parliament and Council Directives, Electromagnetic compatibility Directive (EMC) 2014/30/EC of 26 February 2014. The CE mark above can be used under the responsibility of manufacturer. After completion of an EC declaration of Conformity and compliance with all relevant EC directives.

## CONTACTS

### **Deutschland:**

DIMAX International GmbH Flinger  
Broich 203 -FortunaPark- 40235  
Düsseldorf, Deutschland  
[www.koenner-soehnen.com](http://www.koenner-soehnen.com)

### **Ihre Bestellungen**

[orders@dimaxgroup.de](mailto:orders@dimaxgroup.de)

### **Kundendienst, technische Fragen und Unterstützung**

[support@dimaxgroup.de](mailto:support@dimaxgroup.de)

### **Garantie, Reparatur und Service**

[service@dimaxgroup.de](mailto:service@dimaxgroup.de)

### **Sonstiges**

[info@dimaxgroup.de](mailto:info@dimaxgroup.de)

---

### **The United Kingdom:**

Innovation Trade Ltd.,  
63/66 Hatton Garden Fifth Floor,  
Suite 23, London, EC1N 8LE  
[info.uk@dimaxgroup.de](mailto:info.uk@dimaxgroup.de)

### **Technical support**

[support.uk@dimaxgroup.de](mailto:support.uk@dimaxgroup.de)

---

### **Polska:**

DIMAX International Poland Sp.z o.o.  
Polska, Warszawska,  
306B 05-082 Stare Babice,  
[info.pl@dimaxgroup.de](mailto:info.pl@dimaxgroup.de)  
[www.konner-sohnen.com](http://www.konner-sohnen.com)

---

### **Україна:**

ТОВ «Техно Трейд КС»,  
вул. Електротехнічна 47,  
02222, м. Київ, Україна  
[sales@ks-power.com.ua](mailto:sales@ks-power.com.ua)  
[www.konner-sohnen.com](http://www.konner-sohnen.com)