



PHONES

(044) 360-7-130
 (050) 336-0-130
 (063) 788-0-130
 (067) 233-0-130
 (068) 282-0-130

130

COM.UA

Internet store of autogoods



ICQ

294-0-130
 597-0-130

SKYPE
 km-130

CAR RECEIVERS — Receivers • Media receivers and stations • Native receivers • CD/DVD changers • FM-modulators/USB adapters • Flash memory • Facia plates and adapters • Antennas • Accessories |
 CAR AUDIO — Car audio speakers • Amplifiers • Subwoofers • Processors • Crossovers • Headphones • Accessories | TRIP COMPUTERS — Universal computers • Model computers • Accessories |
 GPS NAVIGATORS — Portable GPS • Built-in GPS • GPS modules • GPS trackers • Antennas for GPS navigators • Accessories | VIDEO — DVR • TV sets and monitors • Car TV tuners • Cameras • Videomodules • Transcoders • Car TV antennas • Accessories | SECURITY SYSTEMS — Car alarms • Bike alarms • Mechanical blockers • Immobilizers • Sensors • Accessories | OPTIC AND LIGHT — Xenon • Bixenon • Lamps • LED • Stroboscopes • Optic and Headlights • Washers • Light, rain sensors • Accessories | PARKTRONICS AND MIRRORS — Rear parktronic • Front parktronic • Combined parktronic • Rear-view mirrors • Accessories | HEATING AND COOLING — Seat heaters • Mirrors heaters • Screen-wipers heaters • Engine heaters • Auto-refrigerators • Air conditioning units • Accessories | TUNING — Vibro-isolation • Noise-isolation • Tint films • Accessories | ACCESSORIES — Radar-detectors • Handsfree, Bluetooth • Windowlifters • Compressors • Beeps, loudspeakers • Measuring instruments • Cleaners • Carsits • Miscellaneous | MOUNTING — Installation kits • Upholstery • Grilles • Tubes • Cable and wire • Tools • Miscellaneous | POWER — Batteries • Converters • Start-charging equipment • Capacitors • Accessories | MARINE AUDIO AND ELECTRONICS — Marine receivers • Marine audio speakers • Marine subwoofers • Marine amplifiers • Accessories | CAR CARE PRODUCTS — Additives • Washer fluid • Care accessories • Car polish • Flavors • Adhesives and sealants | LIQUID AND OIL — Motor oil • Transmission oil • Brake fluid • Antifreeze • Technical lubricant



In store "130" you can find and buy almost all necessary goods for your auto in Kyiv and other cities, delivery by ground and postal services. Our experienced consultants will provide you with exhaustive information and help you to chose the very particular thing. We are waiting for you at the address

<http://130.com.ua>



**2-Motoriger
Autostaubsauger**
DualPower

Bedienungsanleitung

PREMIUM QUALITÄT FÜR AUTOMOBILE

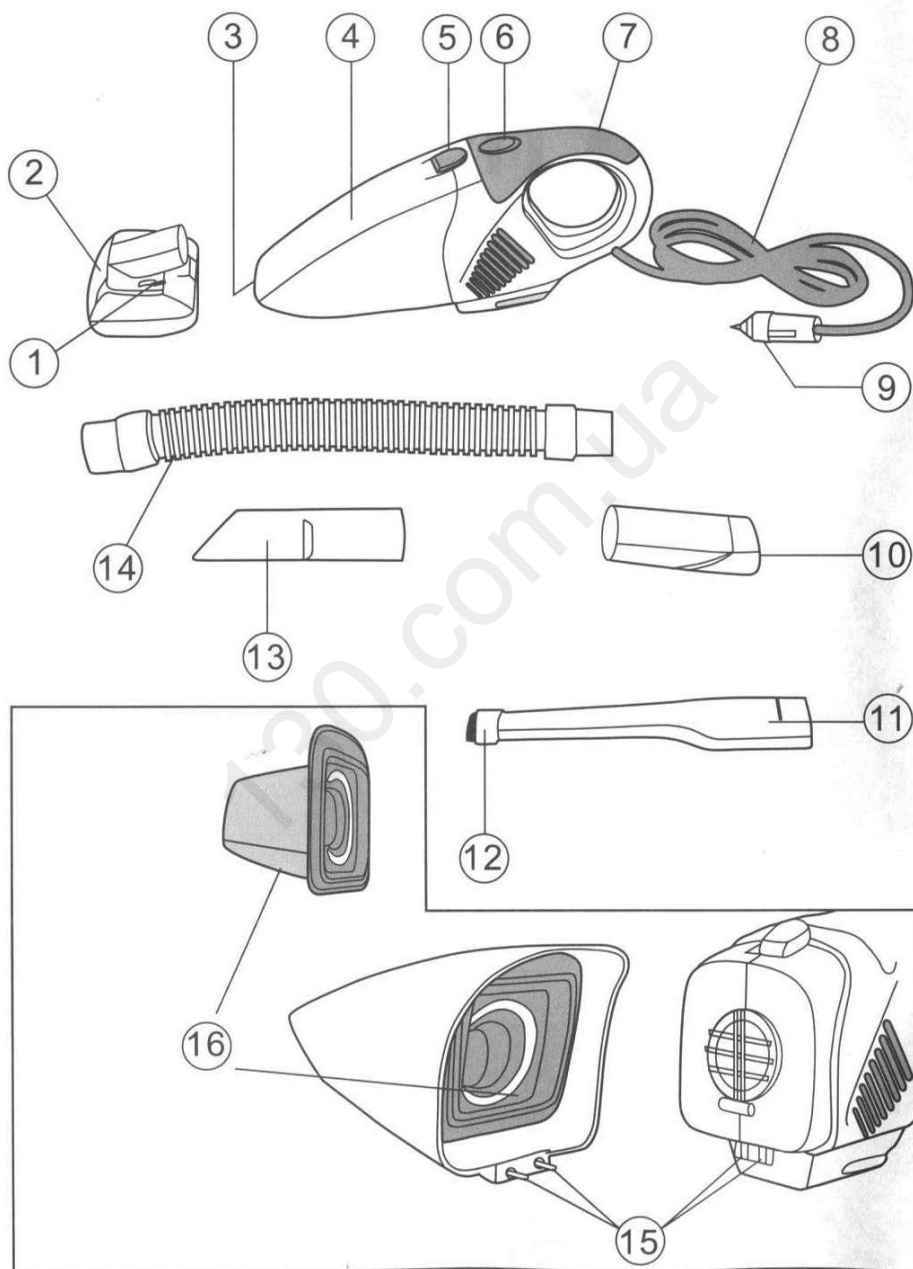



Inhaltsverzeichnis

Deutsch	S. 3 - 5
Englisch	S. 6 - 7
Russisch	S. 8 - 10
Polnisch	S. 11 - 13
Allgemeine Hinweise	S. 14

CAR VACUUM CLEANER

Description

1. Contacts of the turbo brush
2. Turbo brush
3. Air inlet
4. Dust-box
5. Dust-box lock button
6. ON/OFF Switch
7. Handle
8. Power cord
9. Power plug
10. Adapter
11. Small crevice nozzle
12. Small crevice nozzle brush
13. Crevice nozzle
14. Flexible hose
15. Connecting contacts
16. Filter

Safety instructions

Always observe safety instructions! This will prevent injuries and damage. Read this instruction carefully before using the vacuum cleaner. Save the instruction as a reference book.

- This model is intended only for dry cleaning. Do not use it to pick up water or other liquids.
 - Do not immerse it into water.
 - Do not use the vacuum cleaner to pick up flammable or combustible liquids (gasoline, cleaning fluids, perfumes, etc.), or use in areas where they may be present.
 - Do not pick up burning or smoking cigarettes, matches, or hot ashes.
 - Use only manufacturers' attachments.
 - This appliance is not intended for use by young children as a toy or by infirm people without supervision. Never leave an appliance unattended when it is switched on.
 - Keep far from your face and eyes.
 - Do not use the vacuum cleaner when some of its openings are blocked.
 - Clean the filters of dust, hair and other things which obstruct normal air intake.
 - Do not use without filters.
 - To disconnect the appliance do not pull the cord, always take up the plug which is inserted into car cigarette lighter.
 - Keep the cord away from heated surfaces and sharp objects.
 - While using make sure that the cord is not pressed between the car doors or windows.
 - Do not use the appliance if it is damaged.
- Ap- oly to the authorized service centres for repair.

- Always unplug the vacuum cleaner after using, while cleaning and while changing the nozzles.
- Keep away from children. Before using, check if the vacuum cleaner or the accessories are damaged.
-

Electrical safety

- The appliance should be supplied from car on-board power system of 12V with grounded minus.
- Do not connect to the voltage with grounded plus or other voltage.
- Car cigarette lighter can be in current if the key is out of ignition. In this case see your car manual.
- Strip contacts voltage is not more than 12 V, that is safe for the user.
- For short circuit protection there is a 10 A thermal fuse (9) mounted in the plug. To change it twist the central plug (9) cap off, change the fuse and twist the cap on (fig. 1).

Usage of the car vacuum cleaner

Remember!

- the best results can be achieved only when the filters are clean and the dust-box is empty.
 - before using make sure that the filter set (16) is in the case of the dust-box (4).
 - do not use the vacuum cleaner for over 30 minutes, because the charge of the car accumulator may be lowered.
- Unwind the power cord and put the plug (9) into the car cigarette lighter. Choose and connect the required nozzle to the air inlet (3). Turn on the vacuum cleaner with the switch (6). After using switch off the vacuum cleaner (6) and take off the plug (9) from the car cigarette lighter. Remove the rubbish and dust from the dust-box.

Turbo brush (2)

- Set the turbo brush (2) into the air inlet (3) up to the stop.
 - Turn the vacuum cleaner on with the switch (6). At the same time the cylindrical brush drive motor will switch on. Cylindrical brush is effective by sweeping small rubbish out of carpet surfaces.
- After using turn (6) the vacuum cleaner off with the switch (6).

Small crevice nozzle(11)

- Put the small crevice nozzle (11) into the air inlet (3). If necessary put the crevice nozzle (11) on the crevice nozzle brush (12).

Crevice nozzle (13)

- Insert the adapter (10) into the air inlet (3), put the crevice nozzle (13) on the adapter (10).

Flexible hose (14)

- Insert the adapter (10) into the air inlet (3), put the flexible hose end (14) of a smaller diameter into the adapter (10).
- Put on the crevice nozzle (13) on the flexible hose end.

Rubbish and dust removal

We recommend removing rubbish and dust each time after the car cleaning.

- Turn off the vacuum cleaner with the switch (6) and take out the plug (9) from the car cigarette lighter.
- Hold the vacuum cleaner by the handle (7) with the dust-box (4) down.
- Press the dust-box lock button (5) and disconnect the dust-box (4). (fig. 2).
- Take out the filter set (16) from the dust-box (4) (fig. 3).
- Turn down the dust-box (4) and remove the rubbish and dust.

Attention: Do not wash the dust-box with water, only dry cleaning is possible.

- Take off and clean from rubbish the netted filter (16) (fig. 5).
- Insert the filter (16) into the dust-box (4).
- Put the dust-box in position. To do this, connect the contacts (15) at a small angle necessary to connect the lock, simultaneously press the dust-box lock button (5) and fully close the dust-box, Release the lock button (5)-(fig. 6).

Cleaning of the filter set

Keep the filters clean (16) as this ensures the vacuum cleaner efficiency. Clean the filters 3, 4 more times a year. The filters are intended for multiple cleaning. If necessary the filters can be changed.

- Take off the dust-box and take out the filter set (16).
- Clean the filter (16) from dust and wash it with warm water.
- Dry the filter (16) before inserting them into the dust-box (fig. 7).

Attention:

- do not wash the filters in the dishwashing machine.
- do not dry the filters with hair-dryer or other heated appliances.

Cleaning of the turbo brush

Take off the turbo brush and remove hairs or threads from the cylindrical brush.

Case of the vacuum cleaner

- Clean the case with a wet cloth.
- Do not permit liquid into the case.
- Do not use solvents or abrasive substances for cleaning.

TECHNICAL CHARACTERISTICS

Power supply:	DC-12 V
Power consumption:	80-90 W
Dust-box capacity:	200 mL
Cord length:	3,6 M.

Guarantee

Details regarding guarantee conditions can be obtained from the dealer from whom the appliance was purchased. The bill of sale or receipt must be produced when making any claim under the terms of this guarantee.

This product conforms to the EMC Requirements as laid down by the Council Directive 2004/108/EC

