



PHONES

(044) 360-7-130  
(050) 336-0-130  
(063) 788-0-130  
(067) 233-0-130  
(068) 282-0-130

130  
COM.UA

Internet store of  
autogoods



ICQ  
294-0-130  
597-0-130

SKYPE  
km-130

CAR RECEIVERS — Receivers • Media receivers and stations • Native receivers • CD/DVD changers • FM-modulators/USB adapters • Flash memory • Facia plates and adapters • Antennas • Accessories |  
CAR AUDIO — Car audio speakers • Amplifiers • Subwoofers • Processors • Crossovers • Headphones • Accessories | TRIP COMPUTERS — Universal computers • Model computers • Accessories |  
GPS NAVIGATORS — Portable GPS • Built-in GPS • GPS modules • GPS trackers • Antennas for GPS navigators • Accessories | VIDEO — DVR • TV sets and monitors • Car TV tuners • Cameras • Videomodules  
• Transcoders • Car TV antennas • Accessories | SECURITY SYSTEMS — Car alarms • Bike alarms • Mechanical blockers • Immobilizers • Sensors • Accessories | OPTIC AND LIGHT — Xenon • Bixenon • Lamps  
• LED • Stroboscopes • Optic and Headlights • Washers • Light, rain sensors • Accessories | PARKTRONICS AND MIRRORS — Rear parktronic • Front parktronic • Combined parktronic • Rear-view mirrors  
• Accessories | HEATING AND COOLING — Seat heaters • Mirrors heaters • Screen-wipers heaters • Engine heaters • Auto-refrigerators • Air conditioning units • Accessories | TUNING — Vibro-isolation  
• Noise-isolation • Tint films • Accessories | ACCESSORIES — Radar-detectors • Handsfree, Bluetooth • Windowlifters • Compressors • Beeps, loudspeakers • Measuring instruments • Cleaners • Carsits  
• Miscellaneous | MOUNTING — Installation kits • Upholstery • Grilles • Tubes • Cable and wire • Tools • Miscellaneous | POWER — Batteries • Converters • Start-charging equipment • Capacitors  
• Accessories | MARINE AUDIO AND ELECTRONICS — Marine receivers • Marine audio speakers • Marine subwoofers • Marine amplifiers • Accessories | CAR CARE PRODUCTS — Additives • Washer fluid •  
Care accessories • Car polish • Flavors • Adhesives and sealants | LIQUID AND OIL — Motor oil • Transmission oil • Brake fluid • Antifreeze • Technical lubricant



In store "130" you can find and buy almost all necessary goods for your auto in Kyiv and other cities, delivery by ground and postal services. Our experienced consultants will provide you with exhaustive information and help you to chose the very particular thing. We are waiting for you at the address

<http://130.com.ua>

# ELATE 3 WAY 5/6/9

*Component Systems  
Installation Guide*

130.com.ua



***www.morelhifi.com***

## PACKAGE CONTENT

5", 6", 9" ELATE SW WOOFER

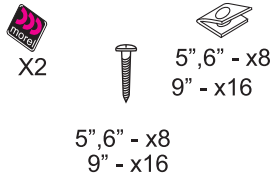
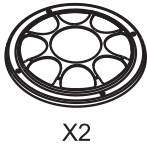
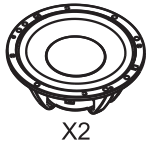

CDM 54 MIDRANGE

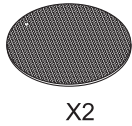

CROSSOVER ACCUSET MX-33

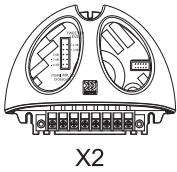

MT-23 TWEETER



GRILL OPTION

SURFACE OPTIONS



## DRIVE UNITS & CROSSOVER MOUNTING

CDM 54 MOUNTING

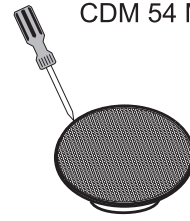

Option 1



Option 2

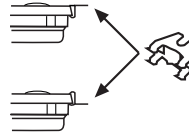

Use the screw clips in any combination, with or without the plastic frame. These clips can be used either way up down depending on installation requirements.

5", 6", 9" UNIT MOUNTING

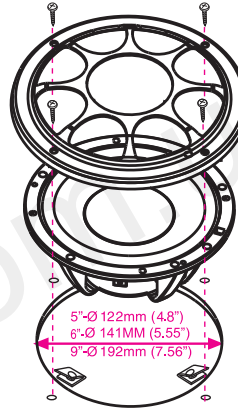

CROSSOVER MOUNTING

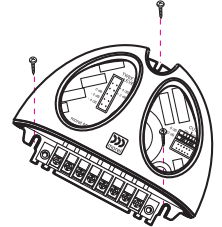

WIRES CONNECTION

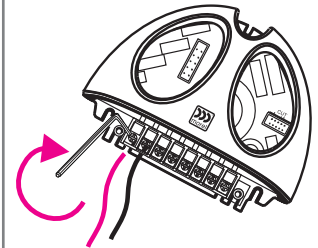

## TWEETER MOUNTING

FLUSH MOUNTING

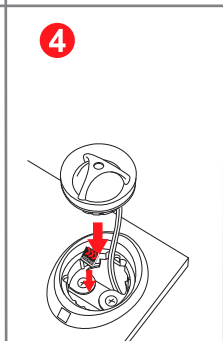
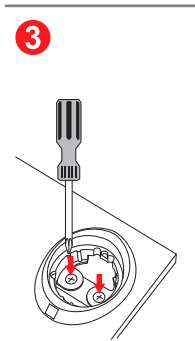
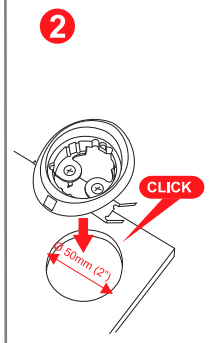
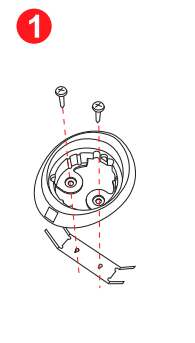

SURFACE MOUNTING

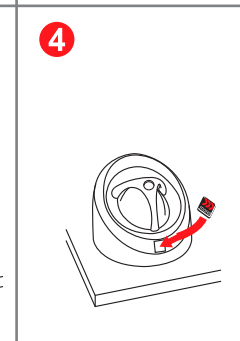
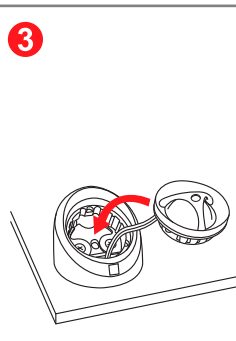
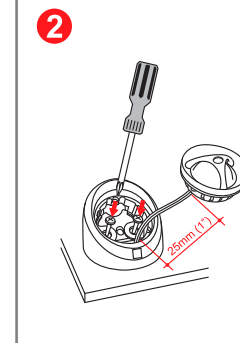
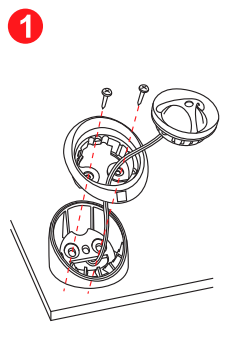

OPTION 3

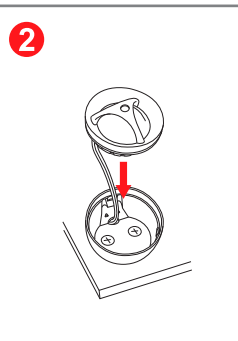
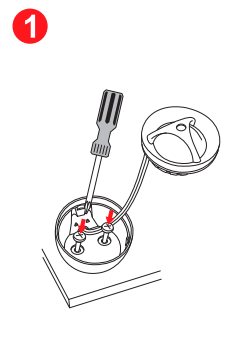

OPTION 4

USE M3 SCREW SIZE

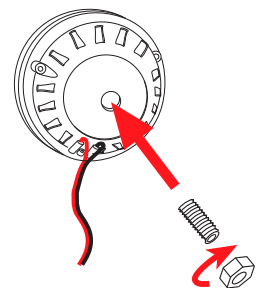

# WIRING OPTIONS FOR ACCUSET MX-33 CROSSOVER

**1 Standard wire connection**  
With bridged Jumpers

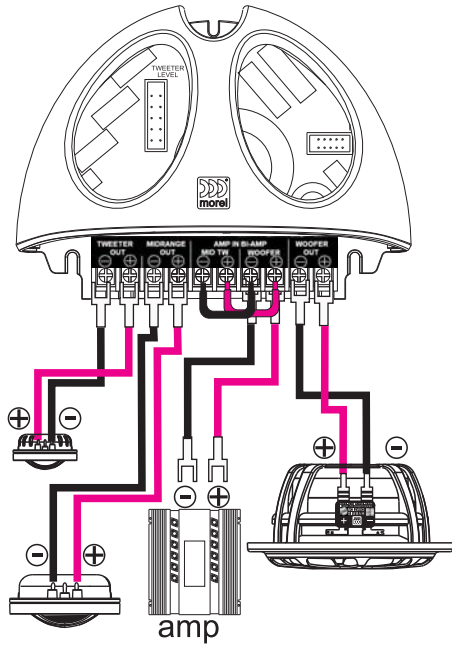

**2 Bi Wire connection** No bridged jumpers

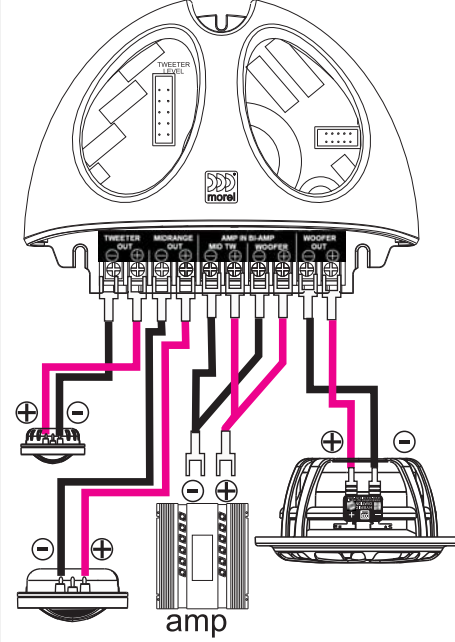

**3 Bi Amp connection** No bridged jumpers

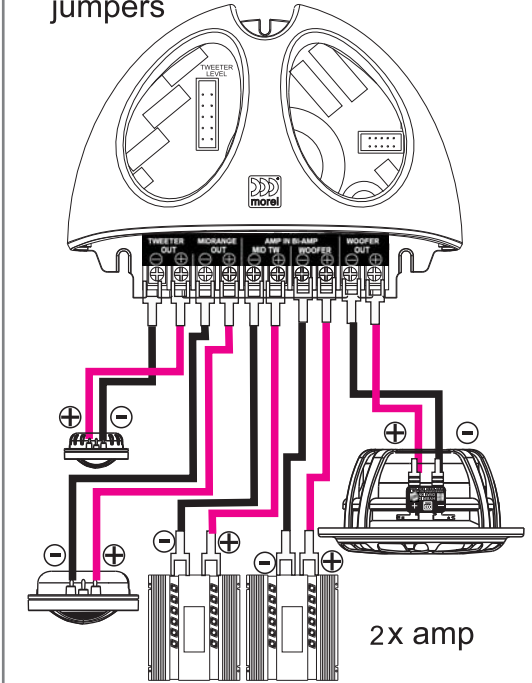

## ACCUSET MX-33 CROSSOVER ALIGNMENT SYSTEM

Use the black jumper to determine the tweeter level and crossover slope cut

Use the black jumper to determine the midrange and crossover slope cut

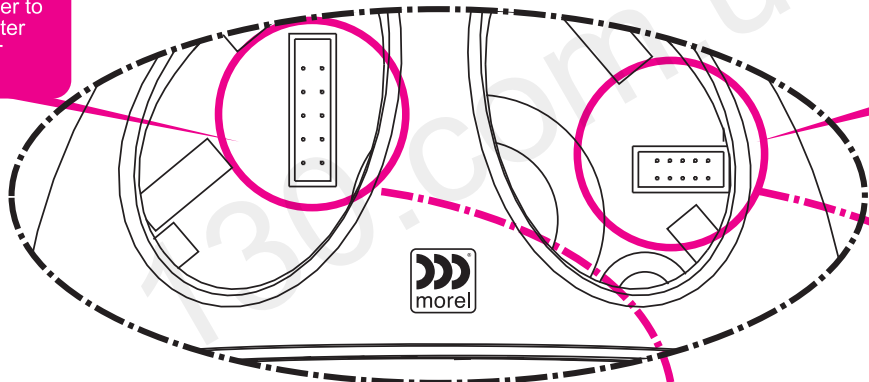

## ACCUSET ALIGNMENT SYSTEM

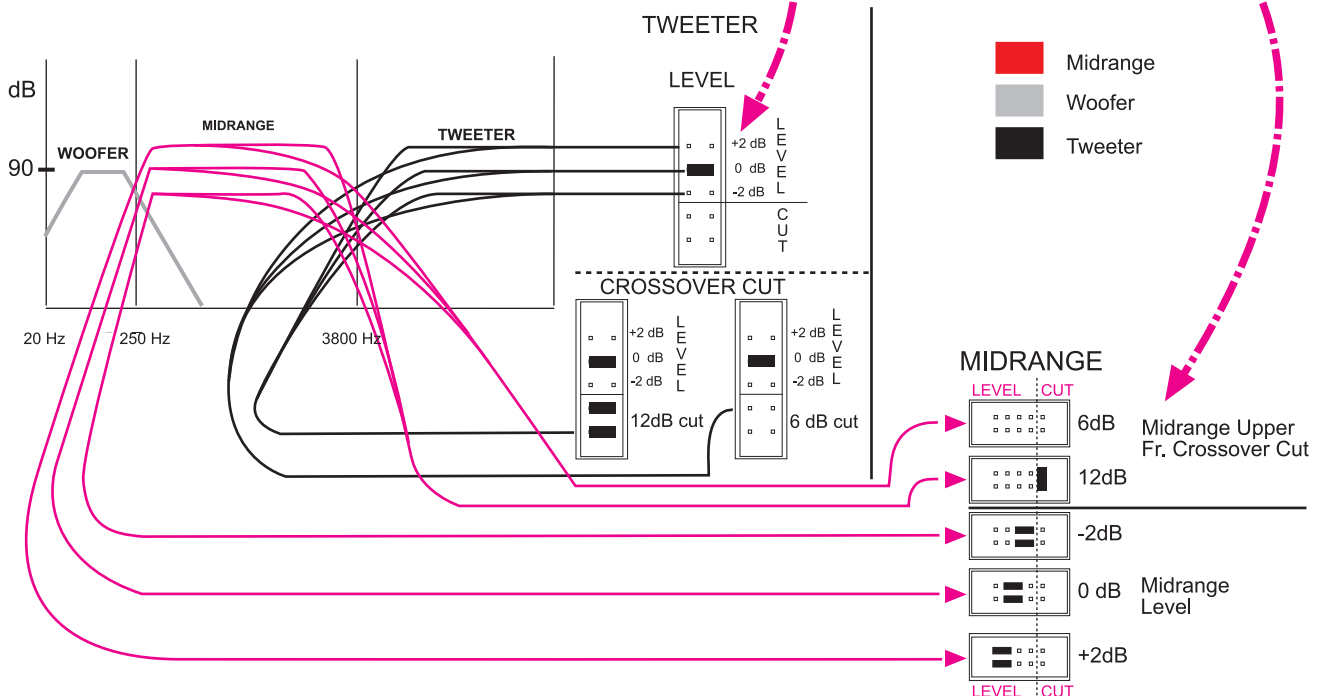

# ELATE™ 3-WAY SPECIFICATIONS

## 5" SYSTEM SPECIFICATIONS

Nominal Impedance	4 Ohm
Power Handling	160W
Max. Transient Power Handling	1000W
Sensitivity (2.83V/1M)	88dB
Frequency response	35-25000Hz

## 5" WOOFER SPECIFICATIONS

Nominal Impedance	4 Ohm
Power Handling	160W
Max. Transient Power Handling	1000W
Sensitivity (2.83V/1M)	88dB
Frequency response	35-5000Hz
FS	55Hz
Voice Coil Diameter	75mm (3")
Voice Coil Height	14.5mm (0.57")
Voice Coil type/ Former	Aluminum
Voice Coil Wire	Hexatech Aluminum
DC Resistance	3.7 Ohm
Voice Coil Inductance @1KHz	0.39mH
Magnet system	Hybrid Rear Vented
HE- Magnetic Gap Height	6mm (0.25")
B- Flux density	0.8T
BL Product/BXL	6.15
Max Linear Excursion/Xmax	8.5mm (± 4.25)
Suspension Compliance CMS	676
Mechanical Q factor QES	0.42
Total Q Factor Q/T	0.35
QMS	1.99
Mechanical Resistance RMS	1.03KgS <sup>1</sup>
Moving Mass MMS	11.8gr
Equivalent Cas Air Load VAS	8 Liters
Effective piston area SD	90cm <sup>2</sup>
Cone Type	One Piece Formed
Cone Material	DPC(Damped Polymer Composite)
Unit Diameter	135mm (5.25")
Mounting Depth	60mm (2.36")
Mounting Cutout	136mm (5.36")Dia.
Net Weight	1.050Kg (2.31 lb)

## 6" SYSTEM SPECIFICATIONS

Nominal Impedance	4 Ohm
Power Handling	200W
Max. Transient Power Handling	1000W
Sensitivity (2.83V/1M)	89dB
Frequency response	25-25000Hz

## 6" WOOFER SPECIFICATIONS

Nominal Impedance	4 Ohm
Power Handling	200W
Max. Transient Power Handling	1000W
Sensitivity (2.83V/1M)	89dB
Frequency response	25-4000Hz
FS	50Hz
Voice Coil Diameter	75mm (3")
Voice Coil Height	14.5mm (0.57")
Voice Coil type/ Former	Aluminum
Voice Coil Wire	Hexatech Aluminum
DC Resistance	3.7 Ohm
Voice Coil Inductance @1KHz	0.38mH
Magnet system	Hybrid Rear Vented
HE- Magnetic Gap Height	6mm (0.25")
B- Flux density	0.8T
BL Product/BXL	6.35
Max Linear Excursion/Xmax	8.5mm (± 4.25)
Suspension Compliance CMS	721
Mechanical Q factor QES	0.39
Total Q Factor Q/T	0.33
QMS	2.06
Mechanical Resistance RMS	1.03KgS <sup>1</sup>
Moving Mass MMS	13.56gr
Equivalent Cas Air Load VAS	14.35 Liters
Effective piston area SD	119cm <sup>2</sup>
Cone Type	One Piece Formed
Cone Material	DPC(Damped Polymer Composite)
Unit Diameter	165mm (6.5")
Mounting Depth	61mm (2.37")
Mounting Cutout	141mm (5.55")Dia.
Net Weight	1.180Kg (2.60 lb)

## 9" SYSTEM SPECIFICATIONS

Nominal Impedance	4 Ohm
Power Handling	200W
Max. Transient Power Handling	1000W
Sensitivity (2.83V/1M)	91dB
Frequency response	20-25000Hz

## 9" WOOFER SPECIFICATIONS

Nominal Impedance	4 Ohm
Power Handling	200W
Max. Transient Power Handling	1000W
Sensitivity (2.83V/1M)	91dB
Frequency response	20-3300Hz
FS	40Hz
Voice Coil Diameter	75mm (3")
Voice Coil Height	14.5mm (0.57")
Voice Coil type/ Former	Aluminum
Voice Coil Wire	Hexatech Aluminum
DC Resistance	3.7 Ohm
Voice Coil Inductance @1KHz	0.72mH
Magnet system	Hybrid Rear Vented
HE- Magnetic Gap Height	6mm (0.25")
B- Flux density	0.9T
BL Product/BXL	7.04
Max Linear Excursion/Xmax	8.5mm (± 4.25)
Suspension Compliance CMS	706
Mechanical Q factor QES	0.42
Total Q Factor Q/T	0.35
QMS	2.09
Mechanical Resistance RMS	1.28KgS <sup>1</sup>
Moving Mass MMS	21.63gr
Equivalent Cas Air Load VAS	47.50 Liters
Effective piston area SD	219cm <sup>2</sup>
Cone Type	One Piece Formed
Cone Material	DPC(Damped Polymer Composite)
Unit Diameter	222mm (8.75")
Mounting Depth	71mm (2.8")
Mounting Cutout	192mm (7.56")Dia.
Net Weight	1.420Kg (3.13 lb)

## TWEETER MT-23 SPECIFICATIONS

Nominal Impedance	6 Ohm
Power Handling	130W
Max. Transient Power Handling	350W
Sensitivity (2.83V/1M)	91dB
Frequency response	1400-25000Hz
FS	950Hz
Voice Coil Diameter	28mm (1.125")
Voice Coil Former	Aluminum
Voice Coil Wire	Hexatech Aluminum
DC Resistance	5.2 Ohm
Magnet system	Double Magnet Neodymium
Dome Type	Acuflex™ Hand Coated Soft Dome Silk
Dome Material	Silk
Unit Diameter	45mm (1.8")Dia.
Mounting Depth	20mm (0.8")
Mounting Cutout	50mm (2")

## ACCUSET MX-33 CROSSOVER

Nominal Impedance	4 ohm
Power handling	250w
Crossover point's	woofer- 300Hz 12dB Midrange low- 300Hz 6dB Midrange high- 3800Hz 6/12dB(variable) Tweeter 3800Hz 6/12dB(variable)
Crossover controls	Midrange: frequency slope cut 6/12dB (upper frequency cut) Level ±2dB (2dB steps) Tweeter: frequency slope cut 6/12dB Level ±2dB (2dB steps)
Wiring options	Standard, bi-amp, bi-wire
Housing material	Die-cast aluminum (Black)
Terminal type	Fully insulated gold plated screw taps.
Net weight	1.050 kg (2.31 lb)

## CDM 54 SPECIFICATIONS

Nominal Impedance	4 Ohm
Power Handling	100W
Max. Transient Power Handling	300W
Sensitivity (2.83V/1M)	91dB
Frequency response	450-7000Hz
FS	300Hz
Voice Coil Diameter	54mm (2.10")
Voice Coil Former	Aluminum
Voice Coil Wire	Hexatech Aluminum
DC Resistance	3.5 Ohm
Magnet system	Neodymium rear vented
Dome Type	Acuflex™ Soft Dome
Dome Material	Soft Dome
Unit Diameter	100 mm (4.0")
Mounting Depth	25mm (1.0")
Mounting Cutout	84mm (3.3")
Net Weight	0.25kg (0.55lb)



[www.morelhifi.com](http://www.morelhifi.com)