



PHONES

0 (800) 800 130  
(050) 462 0 130  
(063) 462 0 130  
(067) 462 0 130

**130**  
COM.UA

Internet store of  
autogoods



SKYPE

km-130

CAR RECEIVERS — Receivers • Media receivers and stations • Native receivers • CD/DVD changers • FM-modulators/USB adapters • Flash memory • Facia plates and adapters • Antennas • Accessories |  
CAR AUDIO — Car audio speakers • Amplifiers • Subwoofers • Processors • Crossovers • Headphones • Accessories | TRIP COMPUTERS — Universal computers • Model computers • Accessories |  
GPS NAVIGATORS — Portable GPS • Built-in GPS • GPS modules • GPS trackers • Antennas for GPS navigators • Accessories | VIDEO — DVR • TV sets and monitors • Car TV tuners • Cameras • Videomodules • Transcoders • Car TV antennas • Accessories | SECURITY SYSTEMS — Car alarms • Bike alarms • Mechanical blockers • Immobilizers • Sensors • Accessories | OPTIC AND LIGHT — Xenon • Bixenon • Lamps • LED • Stroboscopes • Optic and Headlights • Washers • Light, rain sensors • Accessories | PARKTRONICS AND MIRRORS — Rear parktronic • Front parktronic • Combined parktronic • Rear-view mirrors • Accessories | HEATING AND COOLING — Seat heaters • Mirrors heaters • Screen-wipers heaters • Engine heaters • Auto-refrigerators • Air conditioning units • Accessories | TUNING — Vibro-isolation • Noise-isolation • Tint films • Accessories | ACCESSORIES — Radar-detectors • Handsfree, Bluetooth • Windowlifters • Compressors • Beeps, loudspeakers • Measuring instruments • Cleaners • Car seats • Miscellaneous | MOUNTING — Installation kits • Upholstery • Grilles • Tubes • Cable and wire • Tools • Miscellaneous | POWER — Batteries • Converters • Start-charging equipment • Capacitors • Accessories | MARINE AUDIO AND ELECTRONICS — Marine receivers • Marine audio speakers • Marine subwoofers • Marine amplifiers • Accessories | CAR CARE PRODUCTS — Additives • Washer fluid • Care accessories • Car polish • Flavors • Adhesives and sealants | LIQUID AND OIL — Motor oil • Transmission oil • Brake fluid • Antifreeze • Technical lubricant



In store "130" you can find and buy almost all necessary goods for your auto in Kyiv and other cities, delivery by ground and postal services. Our experienced consultants will provide you with exhaustive information and help you to choose the very particular thing. We are waiting for you at the address

<https://130.com.ua>





## 1 PRODUCT OVERVIEW

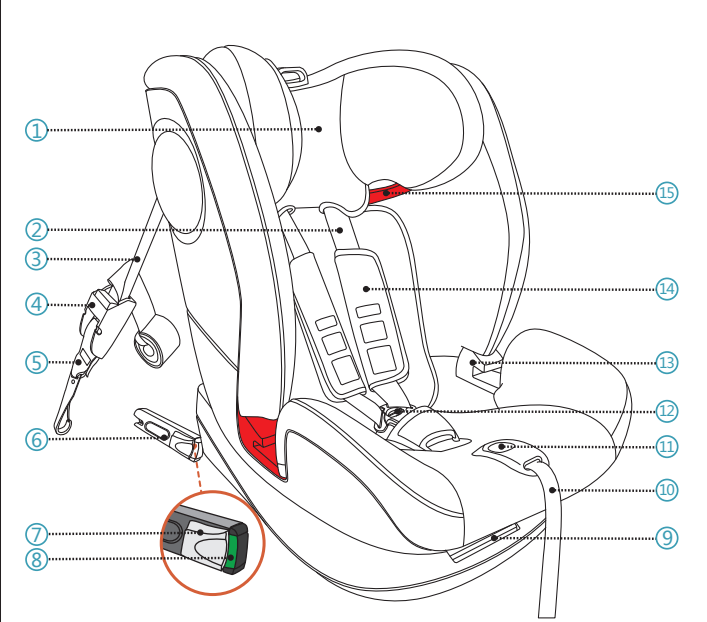

1. Headrest

2. 5-Point Harness

3. Top Tether

4. Top Tether Adjuster

5. Top Tether Hook

6. ISOFIX Connector
7. ISOFIX Locking Button

8. ISOFIX Indicator Lever

9. ISOFIX Stopper

10. 5-Point Harness Adjuster

11. Harness Adjustment Button

12. 5-Point Harness Buckle

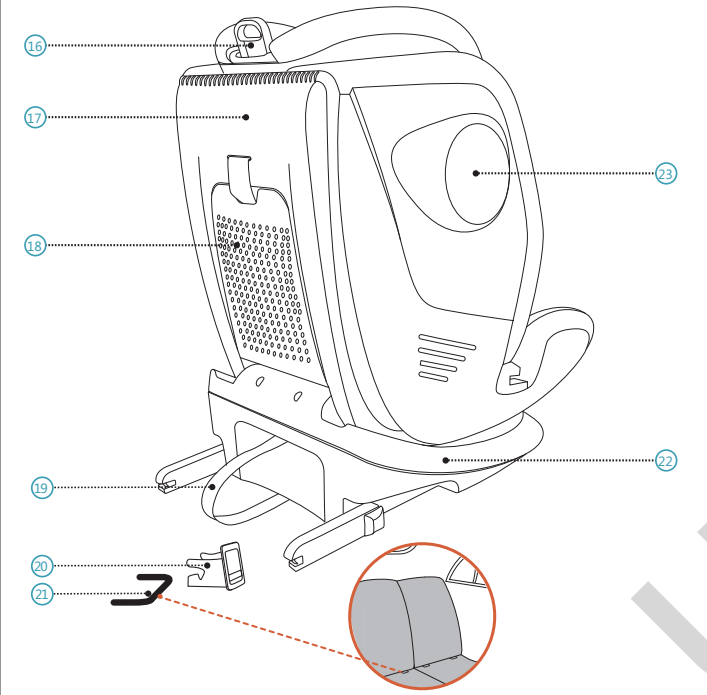

13. Lap Belt Guide

14. Chest Pad

15. Shoulder Belt Guide

16. Headrest Adjuster

17. Backrest

18. Backrest Cover
19. ISOFIX Release Loop

20. ISOFIX Insertion Guide

21. ISOFIX Anchoring Point (Automobile)

22. Seat Base

23. Integrated Side Impact Protection

## 2 INSTRUCTION

Thank you for choosing AVOVA Sanderling-Fix to ensure your child’s safe journey. The seat has been designed, tested and certified according to the UNECE R44, the Child Restraint Systems.

The seal of approval **E** (in a circle) and the approval number are located on the orange approval label (a sticker on the child seat). The child seat is designed for a child with weight of 9-36 kg, approximately from 9 months to 12 years old. It is important that you read this user manual BEFORE installing your child seat. Incorrect installation and/or misuse of the seat could endanger your child. This user manual should be kept behind the Backrest Cover **18** so users can refer to it anytime.

The following symbols are used in this user manual:

**⚠ DANGER** DANGER indicates a hazardous situation which, if not avoided, will result in death or serious injury.

**⚠ WARNING** WARNING indicates a hazardous situation which, if not avoided, could result in death or serious injury.

**⚠ CAUTION** CAUTION indicates a hazardous situation which, if not avoided, could result in minor or moderate injury.

### GENERAL SAFETY INFORMATION

**⚠ DANGER** AVOVA Sanderling-Fix is approved for child weight 9-36 kg in the forward-facing direction.

Mass Group	Installation Type	Install By	Child Weight	ISOFIX Size Class
I	Universal	ISOFIX + Top Tether	9-18 kg	B1
II, III	Universal	3-Point Belt	15-36 kg	
II, III	Semi-universal	3-Point Belt + ISOFIX	15-36 kg	

**⚠ DANGER** AVOVA Sanderling-Fix is a universal child seat with installation in vehicles by ISOFIX and Top Tether for children between 9 kg and 18 kg, and is compatible with most but not all vehicle seats. Please read your vehicle handbook about ISOFIX. For suitable positions in your vehicle, please read your vehicle handbook and our Vehicle type List.

**⚠ DANGER** Please dispose of your child seat in the event of any vehicle and/or violent collision as the child seat may be damaged but the damage may not be immediately visible.

**⚠ DANGER** Do not use lubricants on or modify in any way your AVOVA Sanderling-Fix as this could seriously affect its ability to protect your child.

**⚠ WARNING** Please do not expose the child seat under intensive direct sunlight. Under intensive direct sunlight, the child seat or some of the child seat parts can get very hot which can cause harm to the child.

**⚠ DANGER** Use on the rear seat: Move the front seat forward far enough that the child’s feet cannot reach the backrest of the front seat as that is safer.

**⚠ WARNING** The rigid items and plastic parts of a Sanderling-Fix shall be so located and installed that they are not liable, during everyday use of the vehicle, to become trapped by a movable seat or in a door of the vehicle.

**⚠ CAUTION** The vehicle seats may show signs of wear and tear when using child seats. In order to avoid that, car seat protectors may be used.

**⚠ DANGER** Make sure all passengers are informed about how to release your child in the case of an emergency.

**⚠ DANGER** Make sure luggage or other objects are properly secured. Unsecured luggage may cause severe injuries to children and adults in case of accidents.

**⚠ CAUTION** Do not use any aggressive cleaning products, which may harm the construction material of the child seat.

**⚠ DANGER** AVOVA advises that child seats should not be bought or sold second-hand.

**⚠ WARNING** DO NOT use at home. It’s not designed for home use and can only be used in a vehicle.

**⚠ DANGER** DO NOT use the child seat for longer than 12 years. Due to aging, the quality of the material may change.

**⚠ DANGER** If in doubt, consult either the child seat manufacturer or the retailer.

## 3 INSTALLATION GETTING READY

**⚠ DANGER** Please ensure the vehicle seat on which the child seat is installed is in the upright position if the vehicle seat is reclinable.

**⚠ DANGER** If the vehicle seat headrest interferes with the child seat Headrest **1** in the highest position, adjust the vehicle seat headrest to its highest position or remove it.

### A. INSTALLING WITH ISOFIX AND TOP TETHER

Sanderling-Fix can be installed forward-facing by latching the ISOFIX Connectors **6** to the ISOFIX Anchoring Points **21**, and attaching Top Tether **3** to the vehicle Top Tether Anchoring Point. It is approved as a universal child seat for children with weights of 9-18 kg. It is compatible with universal seating positions in vehicles. Please read your vehicle handbook.

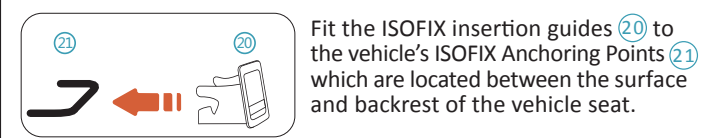

**⚠ CAUTION** It is suggested to use ISOFIX insertion guides to help in the installation. They help to prevent damages to the vehicle seat. If the vehicle seat can be folded, remove the ISOFIX insertion guides before doing so.

**1.** Pull the lower part of ISOFIX Release Loop **19** to pull out ISOFIX Connectors **6** from the child seat base **22**, till both ISOFIX Connectors are at the most outward positions.

**2.** Open the Backrest Cover **18** behind the child seat Backrest **17**. Get the Top Tether **3** out and close the Backrest Cover.

**⚠ CAUTION** When Top Tether is not in use, it can be stored behind the Backrest Cover. Roll the Top Tether and hook it on the locating bar, then close the Backrest Cover. Please refer to the picture in Section 9.

**3.** Position Sanderling-Fix on the suitable vehicle seat. Place the Top Tether at the back of the vehicle seat.

**4.** Push one ISOFIX Connector **6** to engage it with the ISOFIX Anchoring Point **21** with a click sound. Repeat the action on the other side to engage both ISOFIX Connectors.

**⚠ DANGER** Check both ISOFIX indicator levers **8**, and if they both show green the ISOFIX Connectors are locked correctly.

**5.** Squeeze the ISOFIX Stopper **9** at the front end of child seat Base **22**, and push the child seat firmly towards the vehicle seat backrest. Push it as far back as possible until it rests against the vehicle seat backrest.

**⚠ DANGER** Please check that the child seat is connected securely by trying to pull it out from both sides.

**6.** Hold down the button on Top Tether Adjuster **4** and make Top Tether longer. Put the Top Tether to the back of the vehicle seat on top of the vehicle seat headrest or under the vehicle seat headrest.

**7.** Connect the Top Tether Hook **5** onto the vehicle Top Tether Anchoring Point. Your vehicle’s Top Tether Anchoring Point is located in one of the positions shown in the picture. If in doubt, please read your vehicle handbook.

**⚠ DANGER** Top Tether Anchoring Point should show the sign below:



**8.** Pull the loose end of the Top Tether **3** to tension it.

**⚠ DANGER** The green indicators should be visible on the Top Tether adjuster when the Top Tether is correctly tensioned.

**⚠ DANGER** AVOVA Sanderling-Fix is a universal child seat with installation in vehicles by 3-point safety belt for children between 15 and 36 kg, and is compatible with most but not all vehicle seats. For suitable positions in your vehicle, please read your vehicle handbook.

**⚠ DANGER** AVOVA Sanderling-Fix is a semi-universal child seat with installation in vehicles by ISOFIX and vehicle 3-point belt for children between 15 and 36 kg. For suitable positions in your vehicle, refer to the Vehicle Type List and your vehicle handbook.

**⚠ DANGER** When the child is heavier than 36 kg or the child’s shoulders exceed the highest position of the shoulder belt guide **15**, the child must change to the vehicle seat.

**⚠ DANGER** Use the 5-point harness **2** to secure your child when he/she is between 9 kg and 18 kg in weight. Use the vehicle’s 3-point belt to secure your child when he/she is over 15 kg in weight.

**⚠ DANGER** Always use the Young Child Insert before your child is 13 kg in weight.

**⚠ DANGER** Do not use any load bearing contact points other than those described in this user manual and marked on the child seat.

**⚠ DANGER** Never leave your child unattended in the child seat.

**⚠ DANGER** Never secure your child or the child seat with a 2-point belt as that may cause serious injuries or death in the event of an accident.

**⚠ WARNING** The child seat must always be secured when it is in the vehicle, even if no child is being transported, by using either the ISOFIX Connectors **6**, or vehicle 3-point belt when being used without ISOFIX.

**⚠ WARNING** The child seat needs to be checked regularly to ensure all the parts are functioning correctly and free from any damages.

**⚠ DANGER** Make sure the child seat backrest **17** is touching the vehicle seat backrest and the vehicle seat headrest is not pushing the child seat away from the vehicle seat backrest. You may adjust or even remove the vehicle seat headrest if needed.

**⚠ DANGER** Ensure both ISOFIX Indicator Levers **8** and Top Tether Adjuster **4** are showing green signs after installation.

**B. INSTALLING WITH 3-POINT BELT AND ISOFIX**  
Sanderling-Fix can be installed forward-facing by latching the ISOFIX Connectors **6** to the ISOFIX Anchoring Points **21** and using the vehicle’s 3-point belt, approved to UNECE Regulation No.16 or other. It is approved as a semi-universal child seat for children with weights of 15-36 kg and may not fit all vehicle seats. Please read the Vehicle Fitting List and your vehicle handbook.

**1.** Carry out the steps in “Installation” Section Part A INSTALLING WITH ISOFIX AND TOP TETHER, but do not attach the Top Tether **3**.

**2.** Carry out the steps in “Positioning the Child” section Part B.

### C. INSTALLING WITH 3-POINT BELT

Sanderling-Fix can be installed forward-facing using the vehicle’s 3-point belt, approved to UNECE Regulation No.16 or other. It is approved as a universal child seat for children with weights of 15-36 kg, compatible with universal seating positions in vehicles. Please read your vehicle handbook

**⚠ WARNING** Please ensure the ISOFIX Connectors **6** are stowed inside the Seat Base **22** in the fully retracted position.

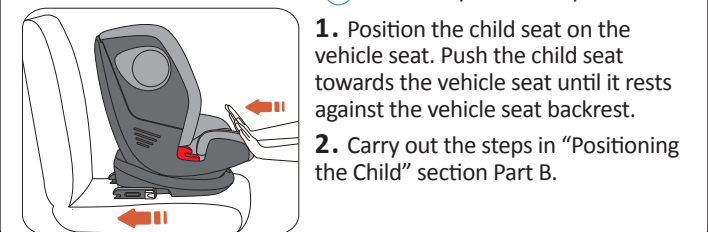

- 1.** Position the child seat on the vehicle seat. Push the child seat towards the vehicle seat until it rests against the vehicle seat backrest.
- 2.** Carry out the steps in “Positioning the Child” section Part B.



## 4 ADJUSTING THE RECLINE

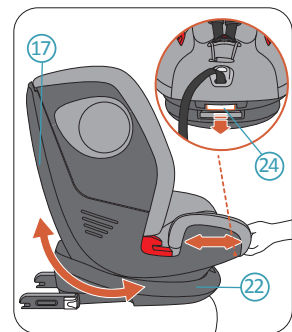

Sanderling-Fix has 3 recline positions. To adjust the recline, squeeze the Recline Adjustment Handle (24) and slide the child seat Backrest (17) by pushing it back and forth against the child seat Base (22).

**⚠ DANGER** Only use the upright position when securing your child with the vehicle 3-point belt.

## 5 ADJUSTING THE HEADREST AND SEAT WIDTH



Sanderling-Fix has 7 Headrest (1) positions. When adjusting the Headrest, the seat width is automatically adjusted simultaneously. To adjust the Headrest, pull and hold the Headrest Adjuster (16) to release the headrest. Pull the Headrest Adjuster up to move the Headrest to higher positions. Hold the Headrest Adjuster and push down the Headrest to move the Headrest to lower positions. When the Headrest is at the desired height, release the Headrest Adjuster to lock the Headrest.

**⚠ CAUTION** You may need to loosen the 5-Point Harness (2) before adjusting the Headrest.

**⚠ CAUTION** The Headrest is accessible to 4 positions with 5-Point Harness. Remove the 5-Point Harness to access the other 3 positions for older children.

## 8 REMOVAL WITH ISOFIX

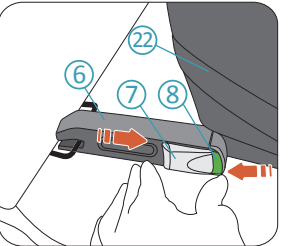

1. Press the ISOFIX Indicator Lever (8) at the lower end and push the ISOFIX Locking Button (7) to release the ISOFIX Connector (6). This action needs to be done to release both ISOFIX connectors. Now you can remove the child seat from your vehicle seat.
2. Store the ISOFIX Connectors by pushing them back into the child seat Base (22).

## 9 REMOVAL AND REFITTING THE 5-POINT HARNESS

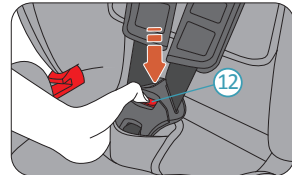

1. Loosen the 5-Point Harness (2), Release the 5-Point Harness Buckle (12). Open the chest pads (14). Detach the chest pads from the straps.

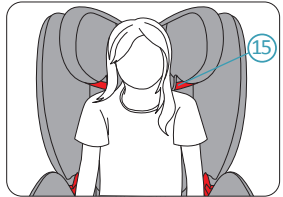
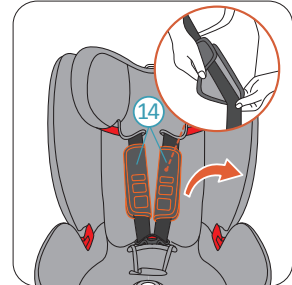

**⚠ DANGER** The Headrest (1) shall be adjusted to the height that the Shoulder Belt Guide (15) is just above the child's shoulders.

## 6 USE OF YOUNG CHILD INSERT

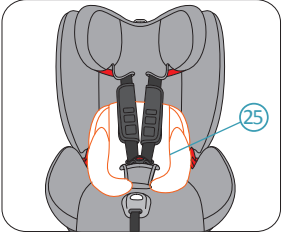

Always use the Young Child Insert (25) when the child weight is below 13 kg.

## 7 POSITIONING THE CHILD

### A. SECURING YOUR CHILD WITH 5-POINT HARNESS

**PLEASE USE THE 5-POINT HARNESS (2) TO SECURE YOUR CHILD WHEN HE/SHE IS 9-18 KG IN WEIGHT.**

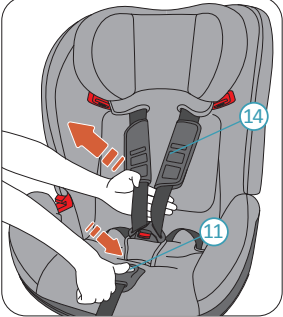

1. Hold down the Harness Adjustment Button (11) before adjusting the Headrest. Pull shoulder harness towards you as much as possible. Make sure you pull the shoulder harness from beneath the Chest Pads (14) as shown.

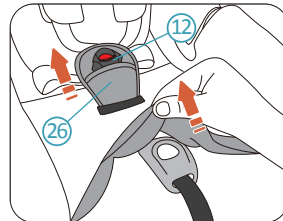

2. Pull out and remove the crotch pad (26). Insert the 5-Point Harness Buckle (12) through the hole in the cover.

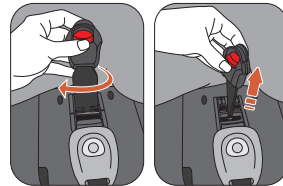

3. Remove the 5-Point Harness Buckle along with the crotch strap out from the H shaped hole in the child seat.

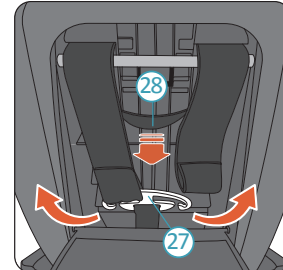

4. Open the Backrest Cover (18). Remove the shoulder harness from the metal connecting piece (27). Pull out and remove the Chest Pads connecting strap (28).

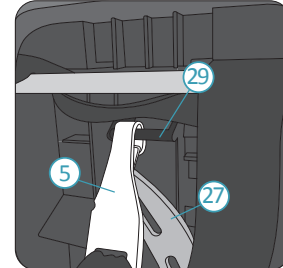

5. Hook the Top Tether (3) on the locating bar (29). Attach and lock the metal connecting piece (27) on the Top Tether Hook (5). Close the Backrest Cover (18).

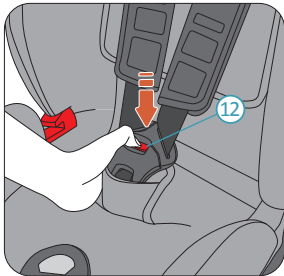

2. Press the red button on the 5-Point Harness Buckle (12) to unbuckle it.

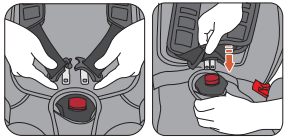

3. Seat your child in the child seat. Route the shoulder harness over your child's shoulders and engage the buckle tongues together. Click the engaged tongues into the buckle body. When the buckle is locked, the green sign will display.



4. Pull both Shoulder Harness to tighten the Lap Harness.

**⚠ DANGER** Please check that the lap strap is worn low down so that the child's pelvis is firmly engaged.

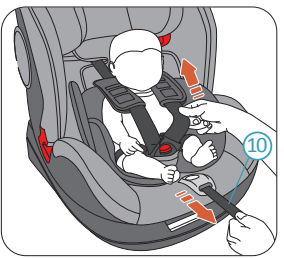

5. Pull the 5-Point Harness Adjuster (10) until the harness firmly secures your child.

**⚠ DANGER** Please check after tightening that none of the harness straps are twisted.

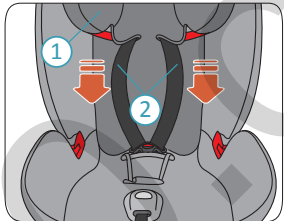

6. Go to the front of the child seat. Pull out and remove the 5-Point Harness (2) straps from the Headrest (1). Hide the harness straps behind child seat cover, then restore the cover.

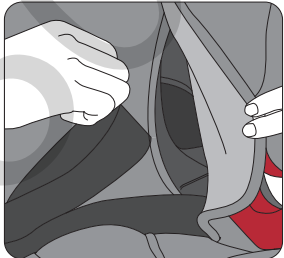

7. Please keep the removed Chest Pads, chest pad connecting strap, crotch pad, 5-Point Harness Buckle and crotch strap well.

**REFITTING THE 5-POINT HARNESS.** Refit the harness in reverse order. If you have any question, please contact AVOVA for help.

## 10 CARE AND MAINTENANCE

You may want to remove and wash the cover or Young Child Insert from time to time. Please do so with mild detergent in the delicates programme of the washing machine (30°C). Please refer to the washing label of the cover. The plastic parts can be cleaned with a mild soap and water.

**⚠ DANGER** The child seat must not be used without the AVOVA seat cover. The cover is a safety feature and may only be replaced by an original AVOVA cover.

Autogoods "130"

## B. SECURING YOUR CHILD WITH 3-POINT BELT

**PLEASE USE THE 3-POINT BELT TO SECURE YOUR CHILD WHEN HE/SHE IS 15-36 KG IN WEIGHT.**

**⚠ CAUTION** Made sure that the Chest Pads, Crotch Pad, 5-point Harness Buckle and crotch strap are removed, and other parts of the harness are properly stored, according to the instructions in Section 8.

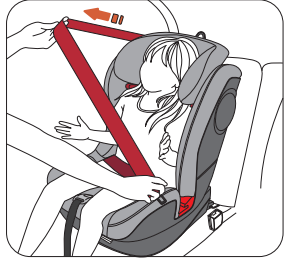

1. Position the vehicle's 3-Point Belt in front of the child, then lock the belt buckle with a click.

**⚠ DANGER** Make sure that the 3-Point Belt is not twisted.

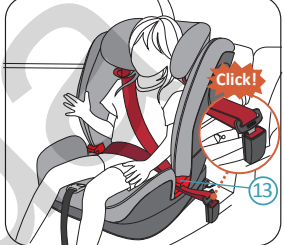

2. Place the shoulder belt section and lap belt section, on the side of the vehicle 3-Point Belt buckle, into the Lap Belt Guide (13).

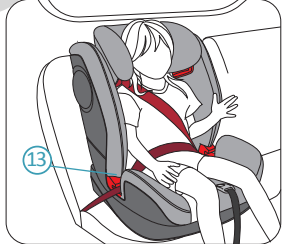

3. Place the lap belt section on the other side of the child seat Backrest into the other Lap Belt Guide.

**⚠ DANGER** The lap belt section must lie as low as possible over the child's pelvis on both sides to provide the best protection.

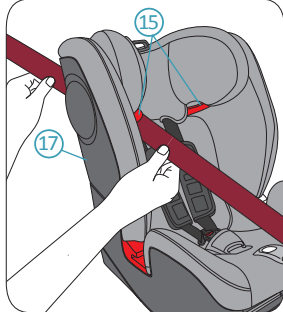

4. Route the shoulder belt section into the Shoulder Belt Guide (15) under the Headrest (1), until it lies completely in the Shoulder Belt Guide and it should not be twisted.

**⚠ WARNING** If the Shoulder Belt Guide is concealed by the child seat Backrest (17), adjust the Headrest upwards to reveal it. Remember to adjust the Headrest back to the correct height.



**⚠ DANGER** Check that the 3-Point Belt runs over your child's collar-bone, not across his/her neck.



5. Pull the shoulder belt section that crosses the body of the child to remove the slack from lap belt section. Then pull the 3-Point Belt part above the child seat to remove the remaining slack.

**⚠ DANGER** DANGER AFTER SECURING YOUR CHILD, PLEASE CHECK BELOW BEFORE YOUR TRAVEL:

1. The lap belt section runs in the Lap Belt Guide (13) on both sides of the seat Backrest (17).
2. The shoulder belt section runs in the Lap Belt Guide (13) on the side of the vehicle's 3-Point Belt buckle and the Shoulder Belt Guide (15) on the other side.
3. The vehicle's 3-Point Belt is tight and not twisted. The 3-Point Belt buckle must not be positioned in the Lap Belt Guide.

## REMOVING AND REFITTING THE SEAT COVER

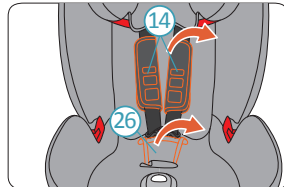

1. Release the 5-Point Harness Buckle (12) (if it is not removed). Open and detach the Chest Pads (14). Pull out and remove the crotch pad (26).

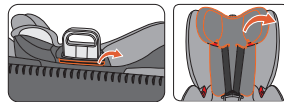

2. Detach the elastic bands on the Headrest (1) cover. Remove the Headrest cover.

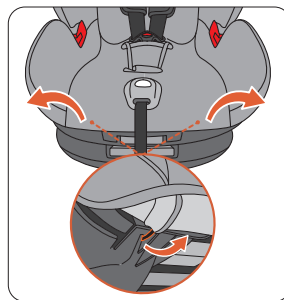

3. Remove the cover of child seat Backrest.

Please refit the cover in the reverse order.

## 11 WARRANTY

1. The warranty for AVOVA Sanderling-Fix lasts for 2 years from the date of original purchase from new. The usage of the product should be in accordance with this user manual. Any damage caused by operations against the instructions in this user manual will void the warranty.
2. Please keep your proof of purchase properly in case of a warranty claim.
3. Never use third parties for maintenance, repair or modification otherwise you will void the warranty. Always check with AVOVA retailers for advice.

If you have any further questions regarding the child seat's use, please feel free to contact us:  
AVOVA GmbH  
Blaubeurer Straße 71  
89077 Ulm  
Germany

T: +49 731 379941-0  
info@avova-childcare.com  
www.avova-childcare.com

## 12 DISPOSAL

When you need to dispose of the child seat, please refer to your local waste disposal regulations. If you have further questions, please contact your communal waste management or administration of your city.