



PHONES

0 (800) 800 130
(050) 462 0 130
(063) 462 0 130
(067) 462 0 130

130
COM.UA

Internet store of
autogoods



SKYPE

km-130

CAR RECEIVERS — Receivers • Media receivers and stations • Native receivers • CD/DVD changers • FM-modulators/USB adapters • Flash memory • Facia plates and adapters • Antennas • Accessories |
 CAR AUDIO — Car audio speakers • Amplifiers • Subwoofers • Processors • Crossovers • Headphones • Accessories | TRIP COMPUTERS — Universal computers • Model computers • Accessories |
 GPS NAVIGATORS — Portable GPS • Built-in GPS • GPS modules • GPS trackers • Antennas for GPS navigators • Accessories | VIDEO — DVR • TV sets and monitors • Car TV tuners • Cameras • Videomodules
 • Transcoders • Car TV antennas • Accessories | SECURITY SYSTEMS — Car alarms • Bike alarms • Mechanical blockers • Immobilizers • Sensors • Accessories | OPTIC AND LIGHT — Xenon • Bixenon • Lamps
 • LED • Stroboscopes • Optic and Headlights • Washers • Light, rain sensors • Accessories | PARKTRONICS AND MIRRORS — Rear parktronic • Front parktronic • Combined parktronic • Rear-view mirrors
 • Accessories | HEATING AND COOLING — Seat heaters • Mirrors heaters • Screen-wipers heaters • Engine heaters • Auto-refrigerators • Air conditioning units • Accessories | TUNING — Vibro-isolation
 • Noise-isolation • Tint films • Accessories | ACCESSORIES — Radar-detectors • Handsfree, Bluetooth • Windowlifters • Compressors • Beeps, loudspeakers • Measuring instruments • Cleaners • Car seats
 • Miscellaneous | MOUNTING — Installation kits • Upholstery • Grilles • Tubes • Cable and wire • Tools • Miscellaneous | POWER — Batteries • Converters • Start-charging equipment • Capacitors
 • Accessories | MARINE AUDIO AND ELECTRONICS — Marine receivers • Marine audio speakers • Marine subwoofers • Marine amplifiers • Accessories | CAR CARE PRODUCTS — Additives • Washer fluid •
 Care accessories • Car polish • Flavors • Adhesives and sealants | LIQUID AND OIL — Motor oil • Transmission oil • Brake fluid • Antifreeze • Technical lubricant



In store "130" you can find and buy almost all necessary goods for your auto in Kyiv and other cities, delivery by ground and postal services. Our experienced consultants will provide you with exhaustive information and help you to choose the very particular thing. We are waiting for you at the address

<https://130.com.ua>

AVAPOW 6000A Multi-function Portable Car Jump Starter User Manual

Model : A68

EN

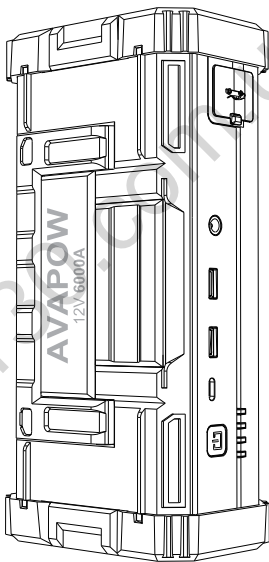



Friendly Tips:

Please carefully read the instruction manual and use product correctly based on the instruction manual so that you can be familiar with the product more conveniently and quickly!

Perhaps there is small difference between the photo and the actual product, so please turn to the actual product for detail information.

What's in the box

- AVAPOW A68 jump starter x1
- Intelligent battery clamps with starter cable x1
- High quality type-C cable x1
- Cigarette lighter converter x1
- User-friendly manual x1
- Delicate carrying case x1

Product diagrams

- 1.Power Button
- 2.USB 1: 5V/2.4A
- 3.USB 2: 5V/3A 9V/2A 12V/1.5A
- 4.EC5 Output / DUST Cover
- 5.Type-C Input: 5V/3A 9V/2A 12V/1.5A
- 6.DC Output: 12V/10A
- 7.LED Light

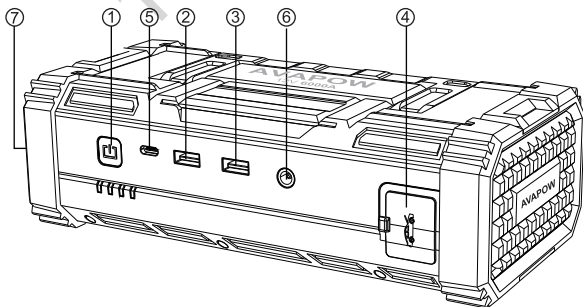

Specifications

Cycle life	> 1000 times
EC5 output	12V / 6000A maximum starting power (max.)
USB1 output	5V/2.4A
USB2 output	5V/3A 9V/2A 12V/1.5A
Type-C input	5V/3A 9V/2A 12V/1.5A
DC output	12V/10A
Charging time	Type-C at 5V/3A: 6H
LED Light	White:1W
Working temperature	-10℃-60℃
Storage temperature	-10℃-60℃
Unit size(LxWxH)	9.14X4.45X2.84 inch
Product accessories	Type-C Line,Start Clamp,Cigarette Lighter Converter,User Manual

Charge the Jump Starter Battery

Charging with an AC adapter (**AC adapter is not included**).

1. Connect the battery input with Type-C cable.
2. Connect the USB cable to AC adapter.
3. Plug the AC adapter into a power source.

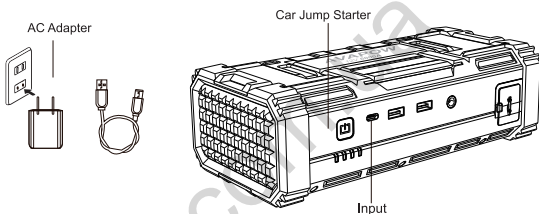

Charge with a car charger (**Note: The car cigarette lighter is not included in the package**).

1. Connect the battery input with car cigarette lighter
2. Plug the charger into the car cigarette lighter hole

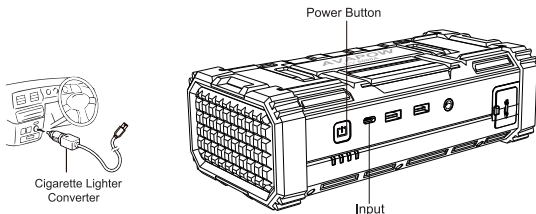

How To Jump Start Your Vehicle



This unit is designed for jump starting 12V car batteries only with a CC rating of 10000CC or less. Do not attempt to jump start vehicles with a higher battery rating, or different voltage.

If the vehicle isn't started immediately, Please wait for 1 minute to allow device to cool down. Do not try to restart the vehicle after three consecutive attempts as this may damage the unit. Check your vehicle for other possible reasons why it can't be restarted.

Operating Instructions:

Ensure this jump Starter batterie has at least 50% or more capacity.

Start The Car

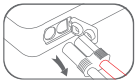
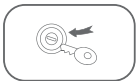
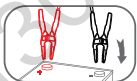
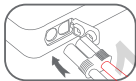

First step:

Insert plug of battery (terminal) into start outlet of start power.

Second step:

Connect the POSITIVE (RED) clamp from the jump starter to the POSITIVE post of the battery. Connect the NEGATIVE (BLACK) clamp to the NEGATIVE.

Third step:

Turn ON the car Engine to start Car.

Fourth step:

Pull out the plug of battery (terminal) from storage battery power supply and remove clips from auto battery.

Jumper Clamp Indicator Instruction

PROTECTION	TECHNICAL PARAMETER	DESCRIPTION	SOLUTION
Short circuit protection	YES	No response	Please use the positive and negative poles of jump cables to connect the positive and negative poles of the car's engine to try to start your car
Reverse connection protection	RC	Wrong connection between jump cable and car's positive and negative poles The RC red light stays on	Keep the correct connection, the positive pole (red) and the positive pole are connected, the negative pole and the negative pole are connected
Standby indication	LED blue light	Jump cables connect jump starter The LED blue light stays on	/
Auto-on status indication	Green light	Jump cables connect to the power of the car after connect the jump starter. The green light stays on	/

PROTECTION	TECHNICAL PARAMETER	DESCRIPTION	SOLUTION
High temperature protection temperature	$80^{\circ}\text{C}\pm 5^{\circ}\text{C}$	The HT red light stays on and beep long alarm sound; Cut off voltage output	Automatically recover when the temperature drops
Start timeout protection	$20\text{S}\pm 5\text{S}$	Automatically enter the standby state after more than 20 seconds and The LED blue light stays on	You can use it again after disconnecting for a minute
Input low capacity protection	$13.5\text{V}\pm 0.5\text{V}$	When it is detected that the power of the EC5 port is lower than 14V, there is no output at this time, the LC red light stays on and beep long alarm sound.	Please charge jump starter

How To Charge a Mobile Phone or Digital Products?



With A68 powerful jump starter and two USB Output Ports (one is 5V/9V/12V USB Quick Charge) , it can full charge your smartphones and tablets up to 75% faster than a standard charger. And you can charge two devices at the same time using the Powerbank.

DC & USB Power Supply

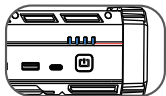
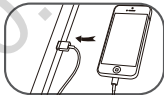
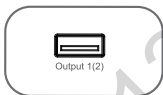

First step:

Plug the USB port of the charging cable into the product USB

Second step:

Inset the other side into the input port of the mobile phone

Third step:

When connected, press the power button, then you can use it to charge now

LED Flashlight



1. Long press the Power button for 3 seconds to turn on the flashlight. The BATTERY CAPACITY indicator lights on. And long press again for 3 seconds to switch the device off completely. If no device is connected to the device, it will automatically switch off.

2. In light mode, e.g. when the LED flashlight is on, short press the Power button to scroll through the lighting, SOS, Strobe. The flashlight offers more than 35 hours of continuous use when fully charged.

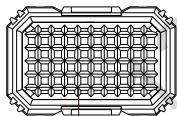

LED Flashlight

Power Button

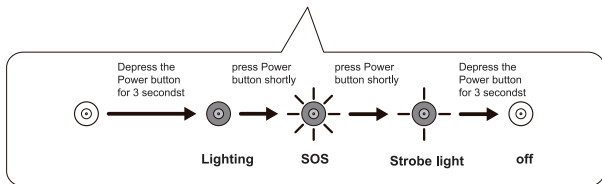
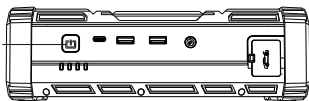



Danger Warning and Caution in handing the battery

1. Never short circuit the jump starter by connecting the Red and Black clamps.
2. Do not disassemble the jump starter.
3. When children use this product, please operate under the guidance of parents.
4. Store in a dry place, do not expose to damp conditions or near corrosive materials.
5. If the jump starter expands, leakage or peculiar smell was found, stop using it immediately.
6. Please use this jump starter at normal temperature and be far away from too wet, too hot and fire.
7. Do not start the vehicle continuously, between starting twice you should allow an interval of at least 30 seconds to 1 minute.
8. When the battery power is less than 10%, do not use the jump starter as it will damage the unit.
9. Before first use, please charge it for 3 hours or more.

In case of misoperation, what shall happen in case of contact between positive and negative polarities of storage battery wire clip?

In case of reverse polarity connection by mistake, the product comes with related protection measurements to avoid life-injury&property loss.

130.com.ua